

INSTRUCTIONS

1. Original and/or subsequent record used to evaluate the corner position.
2. Description of evidence found, note discrepancies in the record, state method of establishing lost or obliterated corners.
3. Description of monument and accessories set to perpetuate the corner position.
4. Sketch or corner, show all pertinent data which can best be shown in a sketch example, corner marking, topography lies, position of accessories, etc.
5. Certification must be signed and sealed by Registered Land Surveyor in State of Montana.
6. Fill in Cross Index & Section Diagram at bottom of sheet.

#62-82-5

CERTIFIED CORNER RECORDATION

Corner NW Cor. Section 28 T. 30N R. 26W P.M.M. Lincoln County

- I. Set 14x8x8 inch limestone, 10 ins. in the ground, with two notches on south, 4 notches on east edges, from which :
- A tamarack 8 ins dia. bears N59°E, 16 lks. marked T30N R26W S21 BT.
 - A tamarack 6 ins. dia. bears S85°E., 7 lks. marked T30N R26W S28 BT.
 - A pine 5 ins. dia. bears S40°W, 22 lks marked T30N R26W S29 BT.
 - A pine 4 ins. dia. bears N41½°W 38 lks. marked T30N R26W S20 BT.
- II. A tamarack 21 ins. dia. scribed T30N R26W S21 BT. All other BT's and corner stones have probably been destroyed by logging in the vicinity of the corner
- III. At record bearing and distance from remaining bearing tree, set a 2½"x30" pipe with 3" aluminum cap, 20 inches in ground marked as shown below and raised a mound of stones 3 ft. in diameter around the pipe, from which the following bearing trees:
- A old tamarack 21" dia. bears N59°E, 16 lks marked T30N R26W S21 BT.
 - A fir 10 ins. dia. bears N69°15'E, 23.5 ft. marked T30N R26W S21 BT.
 - A fir, 10 ins. dia. bears S71°45'E, 6.7 ft. marked T30N R26W S28 BT.
 - A tamarack 12 ins. dia bears S54°30'W, 96.4 ft. marked T30N R26W S29 BT.
 - A fir 12 ins. dia. bears N31°30'W, 47.4 ft. marked T30N R26W S20 BT.

Painted all blazes red, place BT signs on all BT's. Set a fiberglass post alongside the monument and placed a location poster and survey monument sign on a nearby tree.

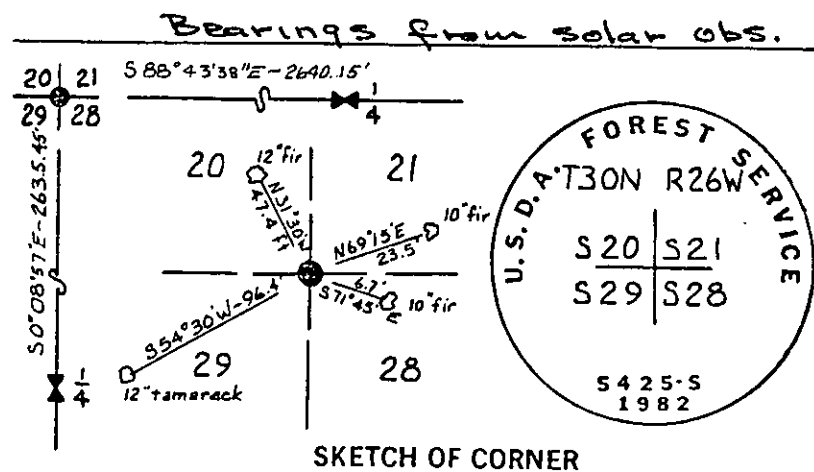

CERTIFICATION

I, _____
certify the information shown herein is true and correct.

Signature Ground Party Chief

William Condrey

I, _____
certify that this Corner Record correctly represents work performed by me or under by direction in compliance with the "Corner Recordation Act" (70-22-101, et seq., M.D.A.)

Signature of Surveyor & Seal

Date: 12-2-82 Reg. No. 5425S

Employer: Associated Surveys, Inc.

Office of Clerk and Recorder, County of Lincoln. This "corner record" was filed for record on the AUGUST 25 day of 1983 was noted on the cross-index plat and is assigned page No. 2324, in book No. _____

Janet BF Siegel by Betty L. Concess
County Official deputy

Cross Index No. R-9 T. 30N R. 26W P.M.M.

Sec. 28

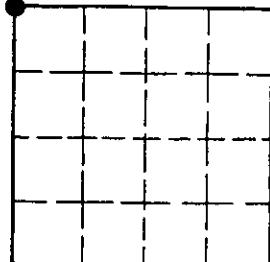

• - corner this sheet