

CERTIFIED CORNER RECORDATION

6 SEC. COR. S6,S7 29 33  
CORNER SEC. COR. S1,S12 T. 29 N., R. 34 W., P.M.M. LINCOLN COUNTY

RECORD:  
Refer to attached Corner Recordation Form

FOUND EVIDENCE:  
A 3 1/4 inch dia. Alum. monument stamped as shown  
A 32 inch DBH Douglas Fir stump with visible scribing bears N27°E 25.3 ft. dist.  
A 20 inch DBH Douglas Fir stump with visible scribing bears N2°E 16.1 ft. dist.

PERPETUATION:  
Established four new bearing trees for the found monument  
From Which  
A 13 inch DBH Cedar scribed T29N R33W S6 BT bears N63°E 25.75 ft. dist.  
A 4 inch DBH Larch scribed X BT bears S53°E 16.4 ft. dist.  
A 6 inch DBH Douglas Fir scribed T29N R34W S12 BT bears S76 1/2°W 20.4 ft. dist.  
A 16 inch DBH Cedar scribed T29N R34W S1 BT bears N81°W 39.4 ft. dist.  
Painted 6 inch wide bands and attached bearing tree tags to all trees

MAGNETIC DECLINATION: 16° E

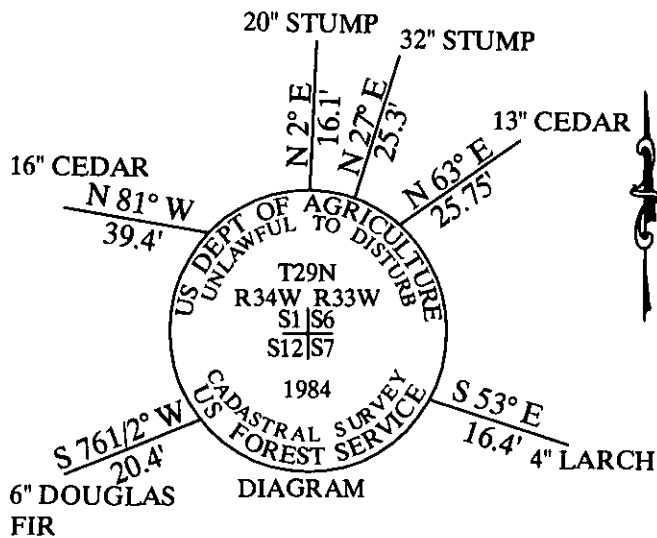

CERTIFICATION  
I, Caleb Williams  
Certify the information shown herein is true and correct  
Signature of Ground Party Chief  
I, Don E. Davis  
certify that this Corner Record correctly represents work  
performed by me or under my direction in compliance with the  
"Corner Recordation act"  
(70-22-101 MRS, M.C.A.)  
Signature of Surveyor & Seal  
Date: 11/10/2009 Reg. No. 4975-S  
Employer: DAVIS Surveying INC

SKETCH OF CORNER

Office of C' 222800 BOOK: CCR CC&R'S PAGE: 11332 Pages: 1  
This "corne STATE OF MONTANA LINCOLN COUNTY  
was noted ( RECORDED: 11/10/2009 3:45 KOI: CC&R'S  
No. TAMMY D. LAUER CLERK AND RECORDER  
In book No FEE: \$0.00 BY: Don E. Davis  
TO: DAVIS SURVEYING, INC. P.O. BOX 896, TROY, MONTANA 59935  
County Official

SECTION

1	6
12	7

Cross Index No. T. 29 N., R. 33 & 34 W., P.M.M. THIS CORNER