

INSTRUCTIONS

1. Original and/or subsequent record used to evaluate the corner position.
2. Description of evidence found, note discrepancies in the record, state method of establishing lost or obliterated corners.
3. Description of monument and accessories set to perpetuate the corner position.
4. Sketch of corner, show all pertinent data which can best be shown in a sketch example, corner marking, topography ties, position of accessories, etc.
5. Certification must be signed and sealed by Land Surveyor registered in the State of Montana.
6. Fill in Cross Index & Section Diagram at bottom of sheet.

CERTIFIED CORNER RECORDATION

Corner 1/4 of Secs. 19 & 30 T. 29 N. R. 33 W. P.M.M. Lincoln County

- I. 1903 G.L.O., original record by John P. Henselwood: "Set a shale stone, 12x10x8 ins., 8 ins. in the ground, for 1/4 sec. cor., marked 1/4 on N. face; from which

A fir, 12 ins. diam., bears N30° W, 3 lks. dist., marked 1/4 S19 BT.
A fir, 12 ins. diam., bears S60° E, 26 lks. dist., marked 1/4 S30 BT."

- II. Found a fractured shale stone, 12x10x6 ins., flush with ground, from which

A fallen fir, 16 ins. diam., bears N1° W, 3 lks. dist., scribe 1/4 S19 is visible
A fir snag, 17 ins. diam., bears S60° E, 26 lks. dist., scribing is visible.

- III. At the position of the found stone, I set a 2 1/2 in. diam. aluminum post, 30 ins. long, 28 ins. in the ground, in a small collar of stone, with a 3 1/4 in. diam., U.S.D.A., Forest Service aluminum cap, marked as shown:

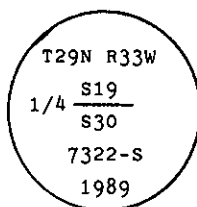

Establish two new bearing trees:

A grand fir, 14 ins. diam., bears N25° W, 8.0 ft. dist., scribed S19 1/4 BT.
A hemlock, 10 ins. diam., bears S3° E, 11.3 ft. dist., scribed 1/4 S30 BT.

Painted red bands around the bearing trees and attached Land Survey Monument and Bearing Tree signs.
Set a 6 ft. galvanized steel guard post with Land Survey Marker and Property Boundary decals, East, 3 ft.
Magnetic Declination: 20° 30' East.

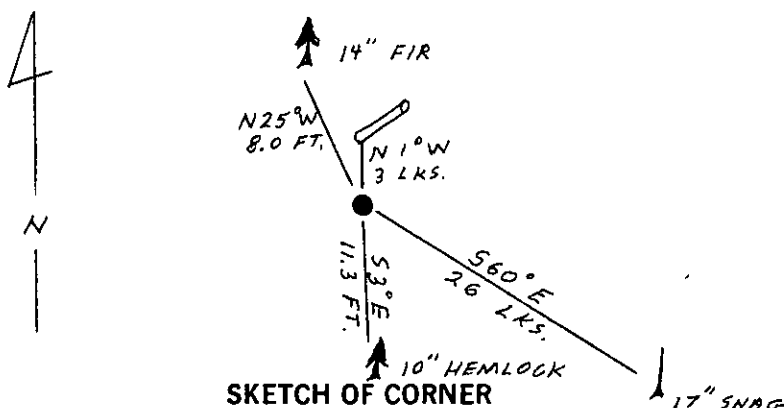

CERTIFICATION

I, Raymond Pederson
certify the information shown herein is true and correct.

Signature Ground Party Chief

I, Alvah F. Hughes
certify that this Corner Record correctly represents work performed by me or under my direction in compliance with the Corner Recordation Act" (70-22-101, et seq., M.C.A.)

Signature of Surveyor Seal

Date: 1/8/90 Reg. No. 7322

Employer: U.S. FOREST SERVICE

Office of Clerk and Recorder, County of Lincoln. This "corner record" was filed for record on Jan 16, 1990 was noted on the cross-index plat and is assigned page No. 4215, in book No. _____

Cross Index No. R-3 T. 29 N. R. 33 W. P.M.M.

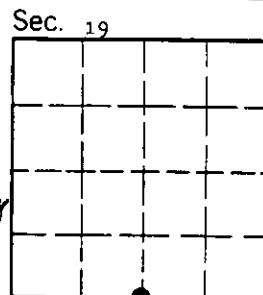

• - corner this sheet