

CERTIFIED LAND CORNER RECORDATION

SECTION 17 Twp. 29 N., R. 33 W., M.P.M.

DESCRIPTION OF CORNER EVIDENCE FOUND, AND ORIGINAL RECORD (IF KNOWN)

- Cor. 1. Brass Cap and Bearing Trees By B.L.M.
 2. Not previously Set
 3. 39.90 Set a Granit Stone 14"X7"X6" 9" in the Ground $\frac{1}{4}$ on N. Face
 Raise a Mound 2 Ft. at Base $1\frac{1}{2}$ Ft. High North of Cor.
 4. Brass Cap and Bearing Trees By B.L.M.
 5. Not previously set
 6. Not previously set
 7 Not previously set
 8. A granite Stone 16"X12"X10" 11" In Ground, from which a 40" Larch Bears
 N 88° E 48 Lks, Scribed $\frac{1}{4}$ S 16 Bt. A 14" Cedar Bears N 40° W 78 Lks.,
 Scribed $\frac{1}{4}$ S 17 BT.

DESCRIPTION OF MONUMENT AND ACCESSORIES ESTABLISHED TO PERPETUATE THE ORIGINAL LOCATION OF THIS CORNER:

Date of work: Oct. 1971

- Cor. 1. Brass Cap and Bearing Trees By B.L.M.
 2. Set a Steel Pin From Which an 8" Larch Bears N 69° E 14.2 Ft A 12" Larch
 Bears S 14° W 6.4 Ft. Both Trees Scribed With $1/16$ BT And Posted
 3. Set a Steel Pin In Road From Which a 6" Pine Bears S $37\frac{1}{2}^{\circ}$ W 29.1 Ft.,
 Scribed $\frac{1}{4}$ S. 17 BT. And Posted. A 12" Pine Bears N 51° E 21.3 Ft.
 Scribed $\frac{1}{4}$ S. 8 BT. And Posted
 4. Brass Cap And Bearing Trees By B.L.M.
 5. Set A Steel Pin
 6. Set A Steel Pin From Which An 8" Fir Bears N 70° W 11.7 Ft. An 8" Fir Bears N 22° E
 9.7 Ft. Both Scribed N $1/16$ W And Posted
 7. Set A Steel Pin In A Rock Pile From Which A 10" Pine Bears S $60^{\circ}45'$ W 11.4 Ft.

SEE REVERSE SIDE OF PAGE

SKETCH, WITH COURSE AND DISTANCE TO ADJACENT CORNERS IF DETERMINED IN THIS SURVEY.
 (MAY SKETCH OR PASTE REPRODUCTION ON REVERSE SIDE.)

SEE SKETCH ATTACHED TO REVERSE SIDE

Surveyor's Seal

Jack H. Ninneman

I, _____
 certify that the information shown herein is true and
 correct.

Jack H. Ninneman
 Signature of Ground Party Chief

Jack W. Ninneman Montana License #534 ES

I, _____
 certify that I have carefully performed or reviewed the
 work done on the diagrammed corner as reported on this
 recordation form and approve the same.

Jack W. Ninneman
 Signature of Surveyor

DIAGRAM OF CORNER:

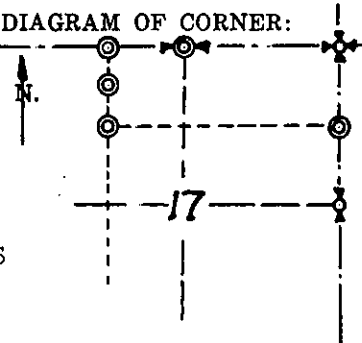

⊙ = Corner recorded on the sheet

534 ES

Registration Number

Office of Clerk and Recorder, County of Lincoln

This "corner record" was filed for record on the 14th day of January 1972, was noted on the cross-index plat and is
 assigned page No. 254, in book No. 1

County Official

Eleanor L. Vaughn, by Betty
Stanchel
 Deputy Mer.

Continued from Reverse Side Sec. 2

Oct. 1971

A 12" Fir Bears S $67^{\circ}30'$ E 10.9 Ft. [REDACTED]
Both Scribed N $1/16$ BT . And Posted

8. Found A Granite Stone And Two Bearing Trees as Recorded By Original Survey

Twp. 29N., R. 33W., M.P.M.

