

# CERTIFIED CORNER RECORDATION

SEC. COR.

CORNER S12,S13,S7,S18T. 29 N., R.33 & 34 W., P.M.M. LINCOLN COUNTY

## RECORD:

Refer to attached 1883 & 1924 GLO notes

## FOUND EVIDENCE:

A 2 1/2 inch dia. Brass Cap Stamped as shown

A dead 15 inch DBH Larch with visible scribing bears S67°W 5.6 ft. dist.

A dead 15 inch DBH Larch with overgrown scribe bears N82°W 15 ft. dist.

A 17 inch stump scribed T29 R33 S7 BT bears N55°W 14.7 ft. dist.

A 14 inch DBH Hemlock scribed T29N R33W S12 BT bears N67°W 29 ft. dist.

## PERPETUATION:

Established Three bearing tree for the found monument

From which

A 5 inch DBH Spruce scribed X BT bears S29°W 2.95 ft. dist.

A 9 inch DBH Hemlock scribed T29N R33W S7 BT bears N28°E 46.1 ft. dist.

A 6 inch DBH Hemlock scribed S18 BT bears S57 1/2°E 32.15 ft. dist.

Painted 6 inch wide bands and attached bearing tree tags to all three trees.

## MAGNETIC DECLINATION: 16° E

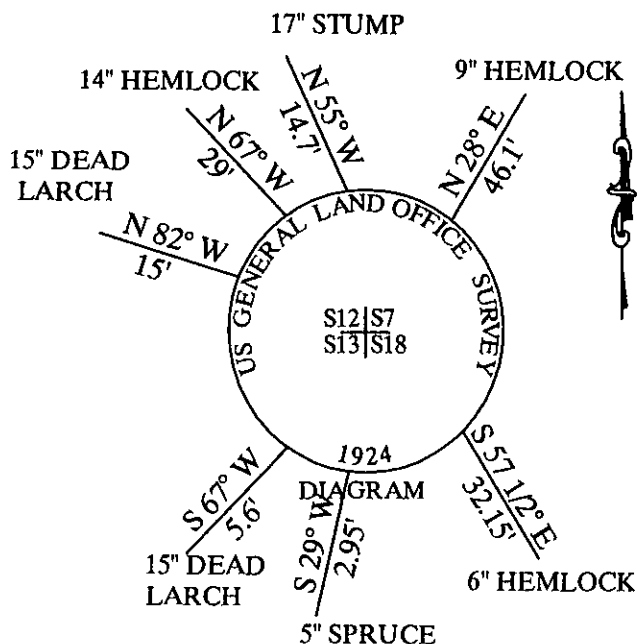

## CERTIFICATION

I, Caleb Williams  
Certify the information shown herein is true and correct

Signature of Ground Party Chief

I, David S. Lauer

certify that this corner record correctly represents work performed by me or under my direction in compliance with the "Corner Recordation Act" (70-2-101 et seq., M.C.A.)

Signature of Surveyor & Seal

Date 11/10/2009 Reg. No. 4975-S

Employer: Davis Surveying Inc

## SKETCH OF CORNER

Office of C 222802 BOOK: CCR CCR'S PAGE: 11334 Pages: 1

This "corn" STATE OF MONTANA LINCOLN COUNTY

was noted RECORDED: 11/10/2009 3:48 KOI: CCR'S

No. TAMMY D. LAUER CLERK AND RECORDER

In book No FEE: \$0.00

TO: DAVIS SURVEYING, INC. P.O. BOX 896, TROY, MONTANA 59935

County Official

## SECTION

12	7
13	18

Cross Index No. T.29 N., R. 33 & 34W., P.M.M.

THIS CORNER