

CERTIFIED CORNER RECORDATION

Corner 1/4 S17/S16 T. 29 N., R. 33 W., P.M.M. Lincoln County

Record :

1903 GLO survey by John P. Henselwood.

"Set a granite stone 16x12x10 ins., 11 ins. in the ground, for 1/4 Sec. Cor. marked 1/4 on W. face, from which:

A Tamarack 40 ins. diam. bears N. 88° E., 48 lks. dist., marked 1/4 S16 BT.

A Cedar 14 ins. diam. bears N. 40° W., 78 lks. dist., marked 1/4 S17 BT."

Found Evidence :

Found a granite stone 11x10 ins., 10 ins. exposed above the ground with 1/4 scribed on it. It appears this stone monument had been disturbed during logging activities in the area.

A Larch snag 37 1/2 ins. diam. bears N. 88° E., 31.68 ft. dist., with visible scribing.

A Cedar 18 ins. diam. bears N. 25° W. (N. 40° W. GLO record), 51.48 ft. dist., with visible scribing.

Perpetuation :

From the original Bearing Trees, set a 2 1/2 inch diam. alum. pipe 30 ins. long, 26 ins. in the ground with a 3 1/4 inch diam. alum. cap marked as shown below, from which:

A Cedar 10 3/4 ins. diam. bears S. 72° E., 15.42 ft. dist., scribed (1/4 S16 BT).

Paint all scribed faces red with 6 inch wide bands around all Bearing Trees.

Attached Bearing Tree signs to all of the trees.

Bury original stone in a collar of stones around alum. monument.

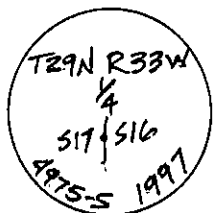

Magnetic Declination: 18° East

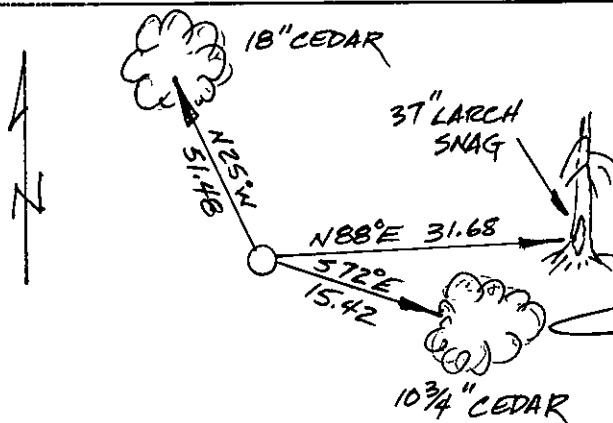

Sketch of Corner

CERTIFICATION

I, John Damon

certify the information shown herein is true and correct

Signature of Ground Party Chief

I, Kenneth E. Davis

certify that this Corner Record correctly represents work performed by me or under my direction in compliance with the "Corner Recordation Act" (70-22-101, et seq. M.C.A.)

Signature of Surveyor & Seal

Date: 1-7-98 Reg. No. 4975 S

Employer: Davis Surveying, Inc.

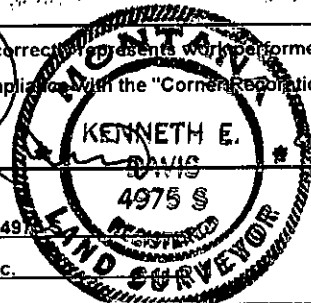

Office of Clerk and Recorder, County of Lincoln

This "corner record" was filed for record on 1-16-98

was noted on the cross-index plat and is assigned page No. 10057

in book No. Coral M. Cummings Bay

County Official ALB

Section

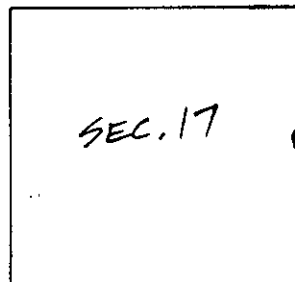

Cross Index No. 1/4 S17/S16 T. 29 N., R. 33 W., PMM

• THIS CORNER