

## INSTRUCTIONS

1. Original and/or subsequent record used to evaluate the corner position.
2. Description of evidence found, note discrepancies in the record, state method of establishing lost or obliterated corners.
3. Description of monument and accessories set to perpetuate the corner position.
4. Sketch of corner, show all pertinent data which can best be shown in a sketch example, corner marking, topography ties, position of accessories, etc.
5. Certification must be signed and sealed by Land Surveyor registered in the State of Montana.
6. Fill in Cross Index & Section Diagram at bottom of sheet.

## CERTIFIED CORNER RECORDATION

of Secs. 9,10,15,16 29 N., 31 W., Lincoln County  
 Corner T. R. P.M.M.  
 I. 1893 G.L.O. Original record by D. P. Mumbrue: Set a 4 ft. wood post as monument and scribed four bearing trees.

1963 B.L.M. Remonumentation record by G. F. Pittman et al: "The cor. of secs. 9,10,15 and 16, monumented with the decayed remains of a wooden post, firmly set in the ground, and witnessed by the remains of the original bearing trees. At the corner point Set an iron post, 30 ins. long, 2 1/2 ins. diam., 26 ins. in the ground, with brass cap mkd.

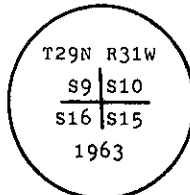

from which

The remains of the original bearing trees:

- A decayed stump, bears N19 3/4° E, 30 lks. dist., visible marks N W. (Record)
- A stump, 24 ins. diam., bears S55 1/4° E, 51 lks. dist., visible marks S15. (Record)
- A dead fir, 14 ins. diam., bears S25 3/4° W, 44 lks. dist., visible marks R31W S16. (Record)
- A decayed stump, bears N23 1/4° W, 20 lks. dist. (Record)

The new bearing trees:

- A fir, 10 ins. diam., bears N39 3/4° E, 37 lks. dist., mkd. T29N R31W S10 BT.
- A fir, 12 ins. diam., bears S52 1/4° E, 26 lks. dist., mkd. T29N R31W S15 BT.
- A larch, 8 ins. diam., bears S10 3/4° W, 24 lks. dist., mkd. T29N R31W S16 BT.
- A pine, 7 ins. diam., bears N63° W, 15 lks. dist., mkd. T29N R31W S9 BT.

Bury the remains of the original wooden post alongside of the iron post."

II. Found an iron pipe, 2 1/2 ins. diam., 5 ins. out of ground, with a 3 1/4 ins. diam. B.L.M. brass cap, marked as shown above, from which

- A root crown, 20 ins. diam., bears N20° E, 19.7 ft. (29.8 lks.) dist., no visible scribe.
- A stump, 24 ins. diam., bears S56° E, 34.3 ft. (52.0 lks.) dist., no visible scribe.
- A broken tree, 15 ins. diam., bears S26° W, 29.7 ft. (45.0 lks.) dist., no visible scribe.
- A root crown, 11 ins. diam., bears N24° W, 13.3 ft. (20.1 lks.) dist., no visible scribe.
- A fir, 13 ins. diam., bears N40° E, 24.0 ft. (36.4 lks.) dist., overgrown scribe.
- A fir, 15 ins. diam., bears S52° E, 16.9 ft. (25.6 lks.) dist., overgrown scribe.
- A larch, 10 ins. diam., bears S11° W, 15.9 ft. (24.1 lks.) dist., overgrown scribe.
- A dead lodgepole pine, 8 ins. diam., bears N63° W, 9.9 ft. (15 lks.) dist., visible marks T29N R31W S9 BT.

III. Established a new bearing tree

A fir, 10 ins. diam., bears N22° W, 30.2 ft. dist., scribed T29N R31W S9 BT.

Attached Land Survey Monument and Bearing Tree signs on bearing trees.

Set a 6 ft. galvanized steel guard post with Survey Marker and Property Boundary decals, South, 3 ft. Magnetic Declination: 20° 30' East.

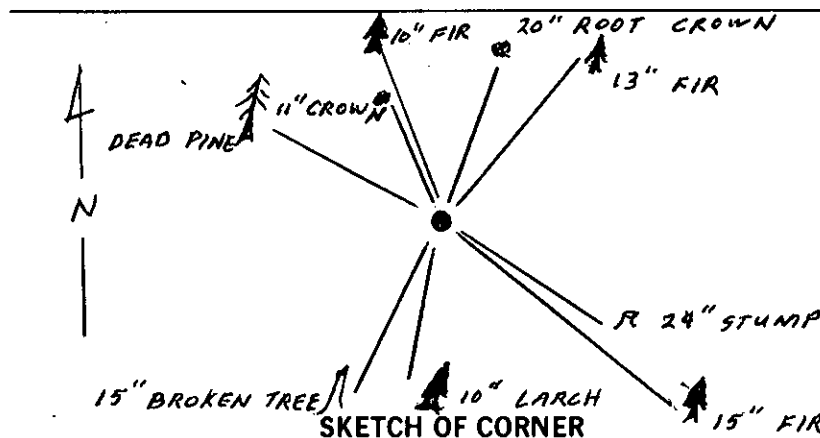

## CERTIFICATION

I, Raymond Pederson  
 certify the information shown herein is true and correct.

Signature Ground Party Chief

Alvah F. Hughes

I, Alvah F. Hughes  
 certify that this Corner Record correctly represents the corner as shown by me or under my direction in compliance with the Montana Corner Recordation Act" (70-22-101, et seq.)

Signature of Surveyor & Seal  
 Date: 6/19/90 Reg. No. 7328

Employer: U.S. FOREST SERVICE

Sec. 9

Office of Clerk and Recorder, County of Lincoln. This "corner

record" was filed for record on Aug 6, 1990

was noted on the cross-index plat and is assigned page No. 4261, in

book No. Grant to Sugil by Bill Buschhoff

County Official

J-13

29 N

31 W

Cross Index No. T. R. PMM

