

INSTRUCTIONS

1. Original and/or subsequent record used to evaluate the corner position.
2. Description of evidence found, note discrepancies in the record, state method of establishing lost or obliterated corners.
3. Description of monument and accessories set to perpetuate the corner position.
4. Sketch or corner, show all pertinent data which can best be shown in a sketch example, corner marking, topography ties, position of accessories, etc.
5. Certification must be signed and sealed by Registered Land Surveyor in State of Montana.
6. Fill in Cross Index & Section Diagram at bottom of sheet.

CERTIFIED CORNER RECORDATION

Corner 1/4 16 15 T. 29N R. 31W P.M.M. Lincoln County

RECORD 1893

Set a post 3 ft. long, 3 ins. square, 24" in the ground for 1/4 corner, marked 1/4 on W. face from which

A pine 10 ins. in diam. bears N 41 1/2° E 25 lks. dist. marked 1/4 S.B.T.

A pine 8 ins. in diam. bears S 16 1/2° W 18 Lks. dist. Marked 1/4 S.B.T.

FOUND

No evidence of corner or bearing trees

MAINTENANCE

We reset the corner by using single proportion measurement between the northeast and southeast section corners.

We set a 3 1/4" diam. standard F.S. cap on alum. pipe, 6" above ground for the corner and marked the following bearing trees.

A 11" diam tamarack bears S 56° W 9.65' dist and scribed 1/4 S 15 B.T.

A 7" diam. tamarack bears N 23° W 9.20' dist. and scribed 1/4 S 16 B.T.

Set a 6' steel post 3' North of corner. Placed BT and land survey monument signs

Painted scribes red and painted red band around the B.T. s

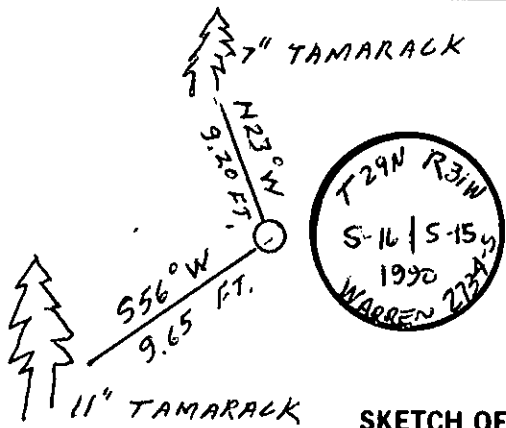
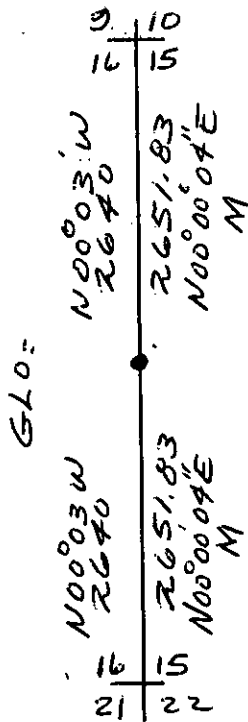

SKETCH OF CORNER

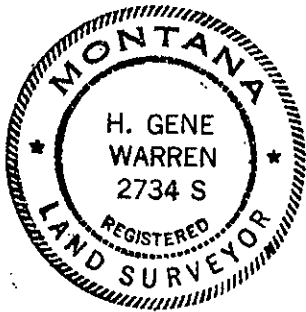

CERTIFICATION

I, Dan Croft certify the information shown herein is true and correct.

Dan Croft
Signature Ground Party Chief

I, H. Gene Warren certify that this Corner Record correctly represents work performed by me or under by direction in compliance with the "Corner Recordation Act" (70-22-101, et seq., M.D.A.)

H. Gene Warren
Signature of Surveyor & Seal

Date: 5/2/90 Reg. No. 2734 S

Employer: Rocky Mtn. Surveyor

Office of Clerk and Recorder, County of LINCOLN. This "corner record" was filed for record on the June 28, 1990 day of 1990, was noted on the cross-index plat and is assigned page No. 4247, in book No. _____

Just B. Segel by Bill Buehler
County Official

Sec. 16

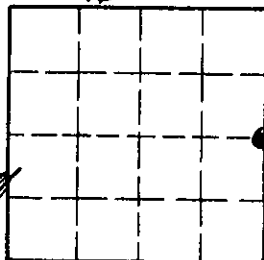

Cross Index No. L-13 T. 29N R. 31W PMM

• - corner this sheet