

# CERTIFIED CORNER RECORDATION

Corner C-E 1/16 S25 T 29 N. R. 31 W. P.M.M. Lincoln County

I. Record: None

II. Found: A field search found no monuments.

III. Perpetuation: At the corner point, determined by survey, set a 5/8 ins. diam. steel rebar 24 ins. long, 5 ins. below existing ground level, with a 3 1/4 ins. diam. Aluminum cap marked as shown below from which:

A 1/2 inch diam. rebar 24 ins. long, bears N00°02'W, 50.00 ft. dist., with plastic cap marked HUGHES 7322LS.

A 1/2 inch. diam. rebar 24 ins. long bears S89°34'13"W, 50.00 ft. dist., with plastic cap marked HUGHES 7322LS.

A Set steel post bears North 1.00 ft. distant with attached location tag.

Magnetic declination: 18° East

Equipment used: Hand compass and loggers tape

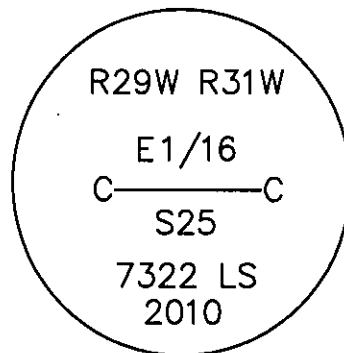

NOTE: Refer to Certificate of Survey No. 4022FC Lincoln County Records for additional survey information.

Kootenai Surveyors Inc., 314 California Av., Libby, MT. 59923 (406) 293-4354

BEEBE Sec. 25

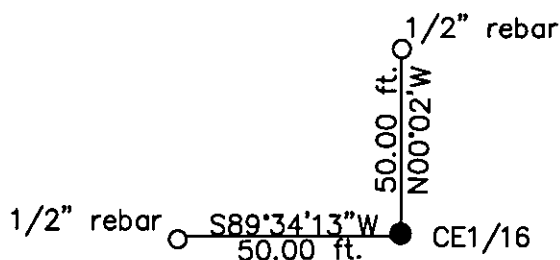

SKETCH OF CORNER

### CERTIFICATION

I, Kelly Rooney  
certify the information shown herein is true and correct.

*Kelly Rooney*  
Signature Ground Party Chief

I, Alvah F. Hughes  
certify that this Corner Record correctly represents work performed by me or under my direction in compliance with the "Corner Recordation Act" (70-22-101, et seq., M.S.A.)

*Alvah F. Hughes*  
Signature of Surveyor & Seal

Date: 06/30/2010 Reg. No. 7322LS

Employer: Kootenai Surveyors Inc.

Office of Clerk and Recorder, County of Lincoln This "corner

record" was fil. 227614 BOOK: CCR CC&R'S PAGE: 11534 Pages: 1

STATE OF MONTANA LINCOLN COUNTY

was noted on RECORDED: 08/09/2010 10:29 KOI: CC&R'S

book No. TAMMY D. LAUER CLERK AND RECORDER

FEE: \$0.00

BY: *Alvah F. Hughes*

TO: KOOTENAI SURVEYORS INC. P.O. BOX 393, LIBBY, MT 59923

Sec. 25

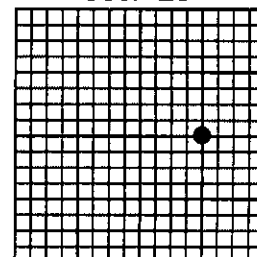

Cross Index No. T 24 T. 29N R. 31W P.M., MT

Adopted July 1, 1981, Montana Board of Professional Engineers & Land Surveyors

• corner this sheet