

CERTIFIED CORNER RECORDATION

CORNER NE1/16 T. 29 N., R. 31 W., P.M.M. LINCOLN COUNTY

RECORD:

NONE

FOUND EVIDENCE:

NONE

PERPETUATION:

Set a 5/8 inch dia. rebar 24 inches long with a 3/4 inch Aluminum cap stamped (see diagram below)

From which:

A 4 inch DBH Lodge Pole Pine scribed X BT bears N30°E 30.4 ft dist.

A 12 inch DBH Douglas Fir scribed NE1/16 S10 BT bears N53°E 17.7 ft dist.

Painted 6 inch wide bands and attached bearing tree tags to both trees.

MAGNETIC DECLINATION: 18° E

4" LODGE POLE PINE

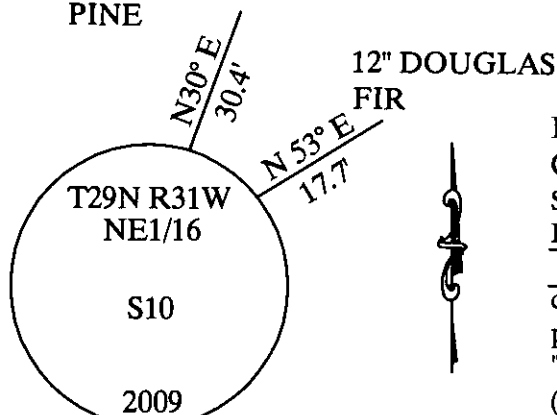

DIAGRAM

12" DOUGLAS FIR

CERTIFICATION

I, George Clark

Certify the information shown herein is true and correct
Signature of Ground Party Chief

I, George Clark

certify that this Corner Record correctly represents work performed by me or under my direction in compliance with the "Corner Recordation act" (70-22-101 et seq. M.C.A.)

George Clark 4975-S
Signature of Surveyor & Seal

Date: 06/18/09 Reg. No. 4975-S

Employer: DAVIS SURVEYING, INC

SKETCH OF CORNER

Office of Clerk and Recorder, County of _____

This "corner" 219608 BOOK: CCR CC&R'S PAGE: 11294 Pages: 1

was noted on STATE OF MONTANA LINCOLN COUNTY

No. _____ RECORDED: 06/18/2009 11:48 KOI: CC&R'S

In book No. _____ TAMMY D. LAUER CLERK AND RECORDER

FEE: \$0.00

BY: Tammy D. Lauer

TO: DAVIS SURVEYING, INC. P.O. BOX 896, TROY, MONTANA 59935

SECTION

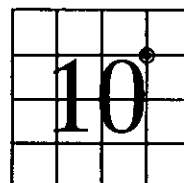

Cross Index No. NE1/16 T. 29 N., R. 31 W., P.M.M.

THIS CORNER