

CERTIFIED CORNER RECORDATION

CORNER E1/16 T. 29 N., R. 31 W., P.M.M. LINCOLN COUNTY

RECORD:

NONE

FOUND EVIDENCE:

Original stone scribed PC 1/16 which bears S89E 6.74 ft. dist. from set monument

PERPETUATION:

Set a 5/8 inch dia. rebar 24 inches long with a 3/4 inch Aluminum cap stamped (see diagram below)
From which:

A 13 inch DBH Douglas Fir scribed E1/16 S3 BT bears N51°E 28.7 ft dist.

A 7 inch DBH Lodge Pole Pine scribed X BT bears S26°E 21.3 ft dist.

Painted 6 inch wide bands and attached bearing tree tags to both trees.

MAGNETIC DECLINATION: 18° E

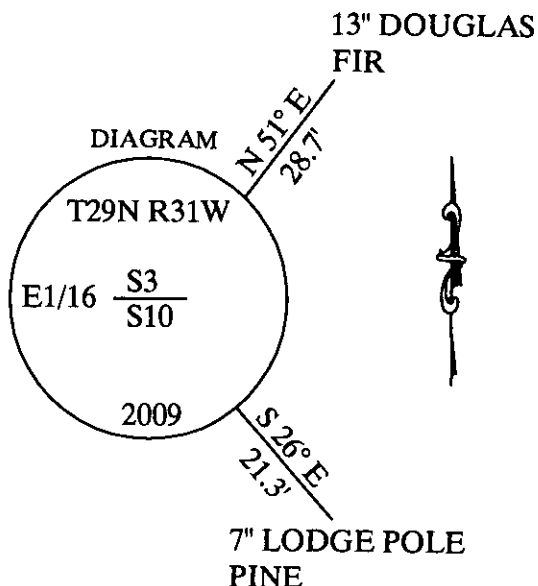

CERTIFICATION

I, George Clark
Certify the information shown herein is true and correct
Signature of Ground Party Chief

I, Dorae Clark
certify that this Corner Record correctly represents work performed by me or under my direction in compliance with the "Corner Recordation Act" (70-22-101, et seq., M.C.A.)

Signature of Surveyor & Seal 4975-3
Date: 6/5 Reg. No. 4975-3
Employer: DAVIS Surveying INC

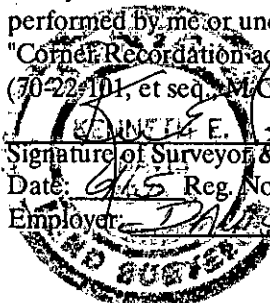

SKETCH OF CORNER

Office of Clerk' 219607 BOOK: CCR CC&R'S PAGE: 11293 Pages: 1
This "corner r STATE OF MONTANA LINCOLN COUNTY
was noted on RECORDED: 06/18/2009 11:47 KOI: CC&R'S
No. TAMMY D. LAUER CLERK AND RECORDER
In book No. FEE: \$0.00 BY: Tammy D. Lauer
TO: DAVIS SURVEYING, INC. P.O. BOX 896, TROY, MONTANA 59935

SECTION

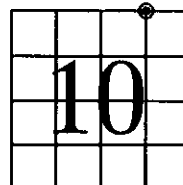

Cross Index No. E1/16 T. 29 N., R. 31 W., P.M.M.

THIS CORNER