

# CERTIFIED CORNER RECORDATION

Corner SE cor. of Sec. 21 T 29 N. R. 31 W. P.M.M. LINCOLN County

I. Record: 1893 GLO survey by Mumbroe: Set a post 4 ft. long, 4 ins. square, 24 ins. in the ground from which:

- A tamarack, 20 ins. diam., bears N.31°E., 42 lks. dist. (27.72 ft.).
- A pine, 10 ins. diam., bears S.8°E., 57 lks. dist. (37.62 ft.).
- A tamarack, 8 ins. diam., bears S.28 1/2°W., 80 lks. dist. (52.80 ft.).
- A pine, 12 ins. diam., bears N.85°W., 93 lks. dist. (61.38 ft.).

1963 - BLM Remon: Set a 3 1/4 ins. diam. brass cap from remains of original wooden post and witnessed by the remains of two original bearing trees from which:

- A larch, 5 ins. diam., bears N.35 1/2°E., 22 lks. dist. (14.52 ft.).
- A fir, 7 ins. diam., bears S.37 1/2°E., 4 lks. dist. (2.64 ft.).
- A larch, 6 ins. diam., bears S.61 3/4°W., 34 lks. dist. (22.44 ft.).
- A larch, 7 ins. diam., bears N.50 1/4°W., 22 lks. dist. (14.52 ft.).

II. Found: A 3 1/4 ins. diam. BLM brass cap firmly set 2 ins. above ground, marked as shown, from which:

- A down, rotted fir, bears S.37 1/2°E., 2.64 ft. dist., (4 lks.), visible scribes.
- A down larch, 6 ins. diam., bears S.61 3/4°W., 22.44 ft. dist., (34 lks.), visible scribes.
- A down larch, 7 ins. diam., bears N.50 1/4°W., 14.52 ft. dist., (22 lks.), visible scribes.

III. Perpetuation:

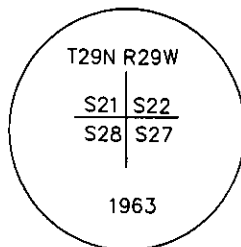

From which:

- A larch, 8 ins. diam., bears N.27°E., 41.10 ft. dist., scribed T29N R31W S22 BT.
- A larch, 13 ins., diam., bears S.29°E., 12.50 ft. dist., scribed T29N R31W S27 BT.
- A larch, 3 1/2 ins. diam., bears S.46°W., 18.00 ft. dist., scribed X BT.
- A larch, 11 ins. diam., bears N.83°W., 10.50 ft. dist., scribed T29N R31W S21 BT.

Painted 6 in. wide red bands around all bearing trees and attached Land Survey Monument and Bearing tree signs.

Set a 6 ft. galvanized steel post 3 ft. north of corner and attached Land Survey Monument decal.

Magnetic declination: 20° East

Equipment used: Hand compass and loggers tape

Kootenai Surveyors Inc., 314 California Av., Libby, MT. 59923 (406) 293-4354

Little Hoodoo - PCTC

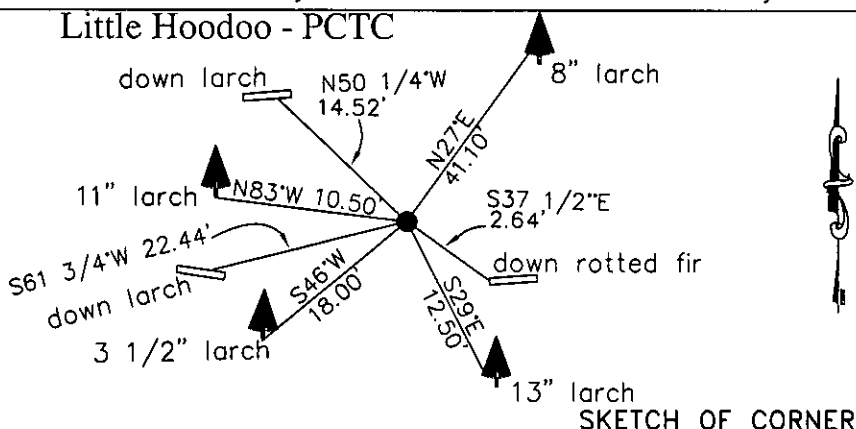

CERTIFICATION

I, Kenneth R. Kern, certify the information shown herein is true and correct.

Kenneth R. Kern  
Signature Ground Party Chief

I, Alvah F. Hughes, certify that this Corner Record correctly represents work performed by me or under my direction in compliance with the "Corner Recordation Act" (70-22-101, et seq., M.C.A.)

Alvah F. Hughes  
Signature of Surveyor & Seal

Date: 6/23/2005 Reg. No. 7322-LS

Employer: Kootenai Surveyors Inc.

Office of Clerk and Recorder, County of Lincoln This "corner

record" was filed for record --

was noted on the cross-i: STATE OF MONTANA LINCOLN COUNTY

book No. 185979 BOOK: CCR CC&R'S RECORDED: 07/14/2005 12:30 KOI: CC&R'S

CORAL M. CUMMINGS CLERK AND RECORDER

FEE: \$0.00

TO: FILED

BY: Flannia

Cross Index No. R 13 T. 29N R. 31W P.M., MT

Adopted July 1, 1981, Montana Board of Professional Engineers & Land Surveyors

Sec. 21

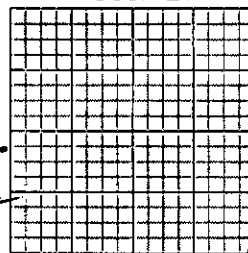

• corner this sheet