

INSTRUCTIONS

1. Original and/or subsequent record used to evaluate the corner position.
2. Description of evidence found, note discrepancies in the record, state method of establishing lost or obliterated corners.
3. Description of monument and accessories set to perpetuate the corner position.
4. Sketch of corner, show all pertinent data which can best be shown in a sketch example, corner marking, topography ties, position of accessories, etc.
5. Certification must be signed and sealed by Land Surveyor registered in the State of Montana.
6. Fill in Cross Index & Section Diagram at bottom of sheet.

CERTIFIED CORNER RECORDATION

Corner S1/16 of Secs. 14 & 15 T. 29 N. R. 30 W. P.M.M. Lincoln County

I. No original record found.

II. No evidence found.

III. At the position determined by survey, set a driveable aluminum rod, 3/4 ins. diam., 30 ins. long, 26 ins. in the ground, with 3 1/4 ins. diam., U.S.F.S., aluminum cap, marked as shown:

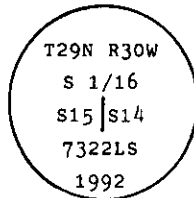

Establish two bearing trees:

A fir, 10 ins. diam., bears S80°E, 2.0 ft. dist., mkd. S 1/16 S14 BT.

A larch, 9 ins. diam., bears S49°W, 28.2 ft. dist., mkd. S 1/16 S15 BT.

Painted red bands around the bearing trees and attached Land Survey Monument and Bearing Tree signs.

Set a 6 ft. galvanized steel guard post with Land Survey Marker and Property Boundary decals, North, 4 ft.

Magnetic Declination: 20° East

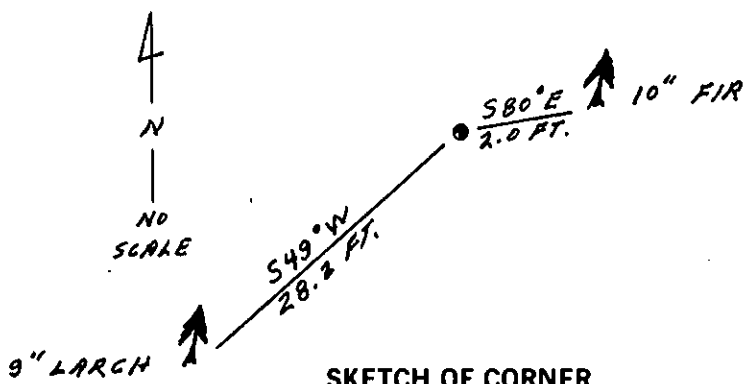

SKETCH OF CORNER

CERTIFICATION

I, Thomas M. Hommel
certify the information shown herein is true and correct.
Thomas M. Hommel
Signature Ground Party Chief

I, Alvah F. Hughes
certify that this Corner Record correctly represents work performed
by me or under my direction in compliance with the "Corner
Recordation Act" (70-22-101, et seq., M.C.A.)
Alvah F. Hughes
Signature of Surveyor & Seal
Date: 12/15/92 Reg. No. 7322 LS 7322LS
Employer: U.S. FOREST SERVICE

Office of Clerk and Recorder, County of Lincoln. This "corner
record" was filed for record on Jan 19, 1993
was noted on the cross-index plat and is assigned page No. 5322, in
book No. _____
Carol M. Cummings
County Official

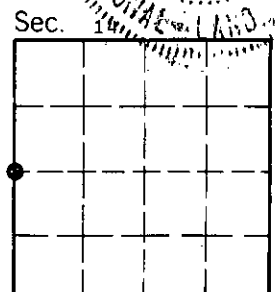

• - corner this sheet

Cross Index No. M-17 T. 29 N R. 30 W PMM