

INSTRUCTIONS

1. Original and/or subsequent record used to evaluate the corner position.
2. Description of evidence found, note discrepancies in the record, state method of establishing lost or obliterated corners.
3. Description of monument and accessories set to perpetuate the corner position.
4. Sketch of corner, show all pertinent data which can best be shown in a sketch example, corner marking, topography ties, position of accessories, etc.
5. Certification must be signed and sealed by Land Surveyor registered in the State of Montana.
6. Fill in Cross Index & Section Diagram at bottom of sheet.

CERTIFIED CORNER RECORDATION

Corner CW 1/16 Sec. 29 T. 29 N. R. 30 W. P.M.M. Lincoln County

- I. 1985 Recordation by Thomas C. Hill, Reg. #5612S: "At the determined corner position, set an aluminum rod, 3/4 ins. diam., 30 ins. long, 30 ins. in ground, with an aluminum cap marked:

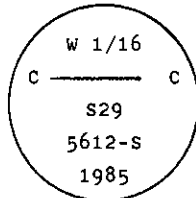

from which the following references:

- A pine, 14 ins. diam., bears N16° E, 29.4 ft. dist., mkd. CW 1/16 S29 BT.
A fir, 9 ins. diam., bears N71° E, 21.4 ft. dist., mkd. CW 1/16 S29 BT.

Set a guard post, with a "Survey Marker" decal attached, 2 ft. East from corner.

Painted a red band around each bearing tree and attached "Attention" and "Bearing Tree" signs where needed.

- II. Found a 3 1/4 ins. diam., U.S.D.A. Forest Service, aluminum cap flush with ground, marked as shown above, from which

- A pine stump, 14 ins. diam., bears N16° E, 29.1 ft. dist., mkd. CW 1/16 S29.
A fir, 9 ins. diam., bears N71° E, 21.4 ft. dist., mkd. CW 1/16 S29 BT.

- III. Establish one new bearing tree:

- A larch, 9 ins. diam., bears N21° E, 37.7 ft. dist., mkd. CW 1/16 S29 BT.

Painted red bands around the bearing trees and attached Land Survey Monument and Bearing Tree signs.

Magnetic declination: 20° East

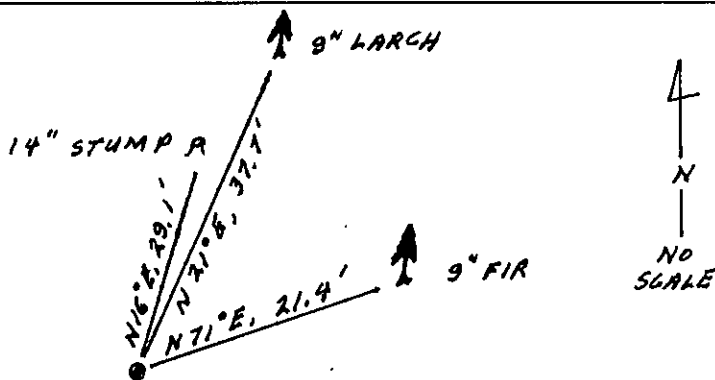

SKETCH OF CORNER

CERTIFICATION

Thomas M. Hommel

- I. certify the information shown herein is true and correct.

Thomas M. Hommel
Signature Ground Party Chief

Alvah F. Hughes

- I. certify that this Corner Record correctly represents work performed by me or under my direction in compliance with the "Corner Recordation Act" (70-22-101, et seq., M.C.A.).

Alvah F. Hughes
Signature of Surveyor & Seal

Date: 12/31/92 Reg. No. 7322LS

Employer: U.S. FOREST SERVICE

Office of Clerk and Recorder, County of Lincoln. This "corner record" was filed for record on Jan 11, 1993 was noted on the cross-index plat and is assigned page No. 5281, in book No. Coral M. Cummings & Co.

County Official

Cross Index No. T-06 T. 29 N. R. 30 W. PMM

Sec. 29

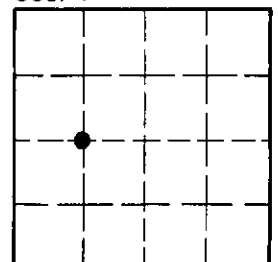

• - corner this sheet