

## INSTRUCTIONS

1. Original and/or subsequent record used to evaluate the corner position.
2. Description of evidence found, note discrepancies in the record, state method of establishing lost or obliterated corners.
3. Description of monument and accessories set to perpetuate the corner position.
4. Sketch of corner, show all pertinent data which can best be shown in a sketch example, corner marking, topography ties, position of accessories, etc.
5. Certification must be signed and sealed by Land Surveyor registered in the State of Montana.
6. Fill in Cross Index & Section Diagram at bottom of sheet.

## CERTIFIED CORNER RECORDATION

Corner 1/4 of Secs. 11 & 14 T. 29 N. R. 30 W. P.M.M. Lincoln County

I. 1898 G.L.O. record by Paul S. A. Bickel: Set a stone monument and two bearing trees.

1981 U.S.F.S. Remonumentation by Thomas C. Hill, Reg. No. 5612S:

"I. Original G.L.O. record: Set a slate stone, 24x10x4 ins., 18 ins. in ground mrk.: 1/4 on North face.  
From which:

- A 10" western larch bears N75° W, 28 lks. Mrk.: 1/4 S11 BT.  
A 12" douglas fir bears S32° W, 33 lks. Mrk.: 1/4 S14 BT.

II. Found a 10"x4" slate stone appr. 7" above ground with 1/4 on North face.  
From which:

- A 14" western larch bears N75° W., 16.8 ft. scribing visible.  
A 16" snag bears S31° W., 21.5 ft. healed face.

III. At the determined corner position: set a 2 1/2" x 30" alum. pipe appr. 25" in ground,  
buried original stone alongside pipe. Alum. cap mrk. as shown:

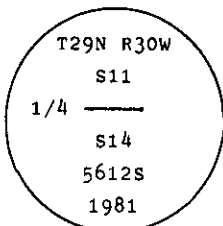

From which:

- An original 14" western larch BT bears N75° W, 16.8 ft.  
A new 3" douglas fir BT bears S14° W, 30.5 ft. mrk.: 1/4 S14 BT.

Painted red bands around BT's, and attached BT signs."

II. Found an aluminum pipe, 2 1/2 ins. diam., 5 ins. above the ground with 3 1/4 ins. diam., U.S.F.S.  
aluminum cap marked as shown above, from which

- A larch, 16 ins. diam., bears N75° W, 16.6 ft. (25 lks.) dist., mkd. 1/4 S.  
A downed snag, bears S31° W, 21.5 ft. (33 lks.) dist., healed face.  
A fir, 5 ins. diam., bears S14° W, 30.5 ft. (46 lks.) dist., healed face.

III. Painted red bands around the bearing trees and attached Land Survey Monument and Bearing Tree signs.

No guard post set.

Magnetic Declination: 20° East

## CERTIFICATION

I, Mark A. Federman  
certify the information shown herein is true and correct.

Signature Ground Party Chief

I, Alvah F. Hughes  
certify that this Corner Record correctly represents work performed  
by me or under my direction in compliance with the "Corner  
Recordation Act" (70-22-101, et seq., M.C.A.)

Alvah F. Hughes  
Signature of Surveyor & Seal HUGHES

Date: 12/15/92 Reg. No. 7322 LS 7322 LS

Employer: U.S. FOREST SERVICE

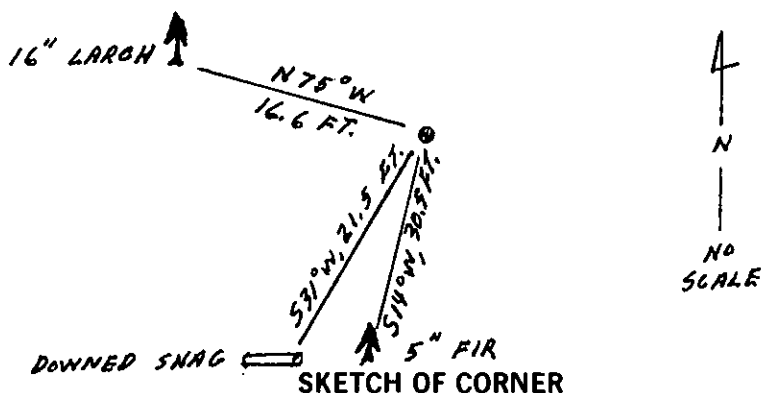

Office of Clerk and Recorder, County of Lincoln. This "corner  
record" was filed for record on 1-4-93  
was noted on the cross-index plat and is assigned page No. 5249, in  
book No.          Coral M. Cummings by BB  
County Official

Cross Index No. J-19 T. 29 N R. 30 W PMM

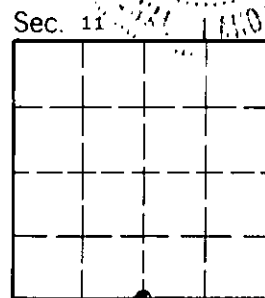

• - corner this sheet