

INSTRUCTIONS

1. Original and/or subsequent record used to evaluate the corner position.
2. Description of evidence found, note discrepancies in the record, state method of establishing lost or obliterated corners.
3. Description of monument and accessories set to perpetuate the corner position.
4. Sketch of corner, show all pertinent data which can best be shown in a sketch example, corner marking, topography ties, position of accessories, etc.
5. Certification must be signed and sealed by Land Surveyor registered in the State of Montana.
6. Fill in Cross Index & Section Diagram at bottom of sheet.

CERTIFIED CORNER RECORDATION

Corner of Secs. 22, 23, 26 & 27 T. 29 N. R. 30 W. P.M.M. Lincoln County

I. 1898 G.L.O. record by Paul S. A. Bickel: Set a stone monument and four bearing trees.

1964 B.L.M. Remonumentation by Gerald F. Pittman et al: "The cor. of secs. 22, 23, 26 and 27, monumented with a slate stone, 18 x 6 x 6 ins., loosely set and mkd. with 2 grooves on the E. and S. faces, and witnessed by the original bearing trees. At the corner point: set an iron post, 30 ins. long, 2 1/2 ins. diam., 27 ins. in the ground, with brass cap mkd.

T29N R30W
S22 S23
S27 S26
1964

from which

The original bearing trees:

- A fir, 19 ins. diam., bears N61°E, 57 lks. dist., visible marks R30W.
(Record: N60°50'E, 57 lks.)
A fir, 16 ins. diam., bears S50°E, 60 lks. dist., mkd. with an overgrown blaze.
(Record: S50°20'E, 60 lks.)
A larch, 16 ins. diam., bears S19°W, 17 lks. dist., mkd. with an overgrown blaze. (Record)
A larch, 16 ins. diam., bears N62 1/2°W, 47 lks. dist., mkd. with an overgrown blaze. (Record)

Bury the original stone alongside of the iron post."

II. Found an iron pipe, 2 1/2 ins. diam., 3 ins. above the ground with 3 1/4 ins. diam., B.L.M. brass cap marked as shown above, from which

- A fir, 21 ins. diam., bears N61°E, 37.6 ft. (57 lks.) dist., visible scribe.
A fir, 21 ins. diam., bears S50°E, 39.6 ft. (60 lks.) dist., healed face.
A larch, 16 ins. diam., bears S19°W, 11.9 ft. (18 lks.) dist., healed face.
A larch, 16 ins. diam., bears N62 1/2°W, 31.4 ft. (48 lks.) dist., healed face.

III. Painted red bands around the bearing trees and attached Land Survey Monument and Bearing Tree signs.

No guard post set.

Magnetic Declination: 20° East

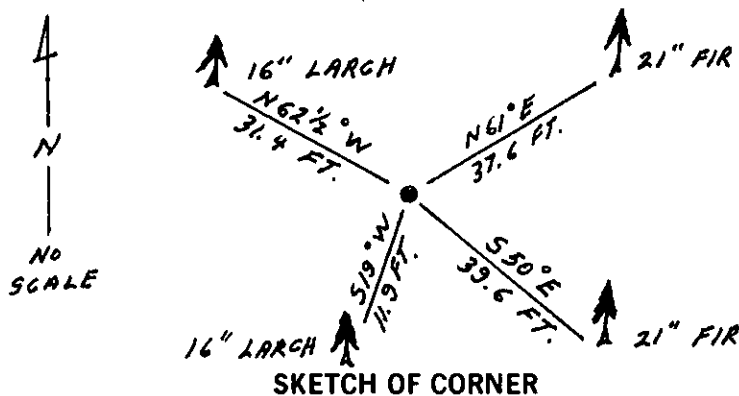

CERTIFICATION

Mark A. Federman

I, certify the information shown herein is true and correct.

Signature Ground Party Chief

Alvah F. Hughes

I, certify that this Corner Record correctly represents work performed by me or under my direction in compliance with the "Corner Recordation Act" (70-22-101, et seq., M.C.A.).

Signature of Surveyor & Seal
Date: 12/11/92 Reg. No. 7322 LS

Employer: U.S. FOREST SERVICE

Office of Clerk and Recorder, County of Lincoln. This "corner record" was filed for record on 1-4-93 was noted on the cross-index plat and is assigned page No. 5246, in book No. Coral M Cummings by DB

County Official

Cross Index No. R-17 T. 29 N R. 30 W PMM

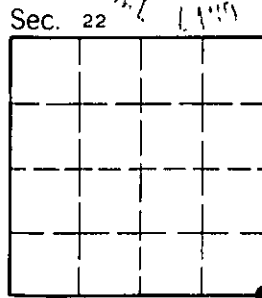

• corner this sheet