

## INSTRUCTIONS

1. Original and/or subsequent record used to evaluate the corner position.
2. Description of evidence found, note discrepancies in the record, state method of establishing lost or obliterated corners.
3. Description of monument and accessories set to perpetuate the corner position.
4. Sketch of corner, show all pertinent data which can best be shown in a sketch example, corner marking, topography ties, position of accessories, etc.
5. Certification must be signed and sealed by Land Surveyor registered in the State of Montana.
6. Fill in Cross Index & Section Diagram at bottom of sheet.

## CERTIFIED CORNER RECORDATION

Corner of Secs. 26, 27, 34, & 35 T. 29 N. R. 30 W. P.M.M. Lincoln County

I. 1898, original G.L.O. record by Paul S.A. Bickel: Set a slate stone and raise mound of stone.

1964, B.L.M. remonumentation by Pittman et al: "The cor. of secs. 26, 27, 34 and 35, monumented with a slate stone, 20x6x6 ins., firmly set and mkd. with 2 grooves on the E. and 1 groove on the S. face, with a small mound of stone, W. of the corner stone.

At the corner point, set an iron post, 30 ins. long, 2 1/2 ins. diam., 27 ins. in the ground, with brass cap mkd.

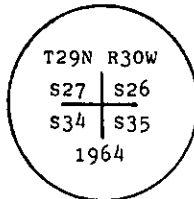

from which

- A larch, 6 ins. diam., bears N35° E, 33 lks. dist., mkd. T29N R30W S26 BT.
- A fir, 18 ins. diam., bears S10° E, 12 lks. dist., mkd. T29N R30W S35 BT.
- A pine, 10 ins. diam., bears S69° W, 40 lks. dist., mkd. T29N R30W S34 BT.
- A pine, 8 ins. diam., bears N75° W, 13 lks. dist., mkd. T29N R30W S27 BT.

Bury the original stone alongside and raise a mound of stone, 3 ft. base, 2 ft. high, W. of the iron post.

II. Found, a 2 1/2 ins. diam. iron pipe, 4 ins. out of ground with a 3 1/4 ins. diam., B.L.M. brass cap marked as shown above, from which

- A larch, 8 ins. diam., bears N35° E, 21.4 ft. (32.4 lks.) dist., overgrown scribe.
- A douglas fir, 22 ins. diam., bears S10° E, 7.8 ft. (11.8 lks.) dist., overgrown scribe.
- A pine snag, 12 ins. diam., bears S69° W, 26.8 ft. (40.6 lks.) dist., mkd. T29N R30W S34 BT.
- A white pine, 9 ins. diam., bears N77° W, 8.2 ft. (12.4 lks.) dist., mkd. T29N R30W S27 BT.
- A mound of stone, 2 ft. dia. x 1 1/2 ft. high, west of cor.

III. Established one new Bearing Tree:

- A larch, 8 ins. diam., bears S25° W, 33.4 ft. dist., mkd. T29N R30W S34 BT.

Painted a red band around each bearing tree and attached Land Survey Monument and Bearing Tree signs.

Set a 6 ft. galvanized steel guard post, with Land Survey Marker and Property Boundary decals attached, 3 ft., South from corner.

Magnetic Declination: East 19°

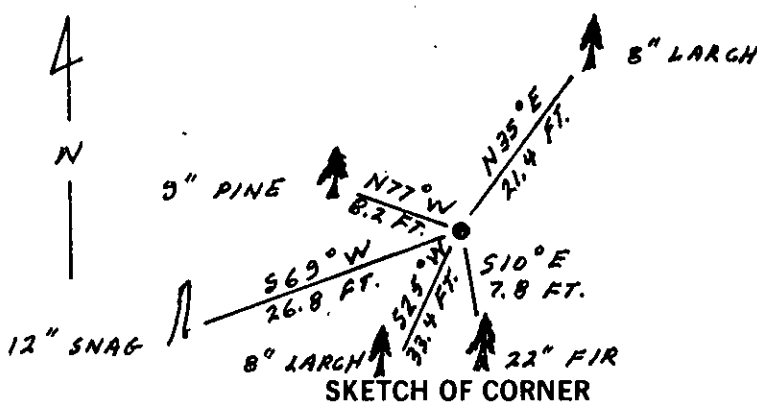

## CERTIFICATION

I. Gary C. Crismon  
certify the information shown herein is true and correct.

Gary C. Crismon  
Signature Ground Party Chief

I. Alvah F. Hughes  
certify that this Corner Record correctly represents work performed by me or under my direction in compliance with the "Corner Recordation Act" (70-22-101, et seq., M.C.A.)

Alvah F. Hughes  
Signature of Surveyor

Date: 12/9/90 Reg. No. 13225

Employer: U.S. FOREST SERVICE

Office of Clerk and Recorder, County of Lincoln. This "corner record" was filed for record on 1-3-91

was noted on the cross-index plat and is assigned page No. 4461 in book No. \_\_\_\_\_

Paul S.A. Bickel  
County Official

V-17  
Cross Index No. \_\_\_\_\_ T. 29 N R. 30 W P.M.M.

