

CERTIFIED LAND CORNER RECORDATION
(REFERENCE FSM 7153.53)

DESCRIPTION OF CORNER EVIDENCE FOUND, AND ORIGINAL RECORD (IF KNOWN)

This corner was established by survey of Libby Airport.

DESCRIPTION OF MONUMENT AND ACCESSORIES ESTABLISHED TO PERPETUATE THE ORIGINAL LOCATION OF THIS CORNER:

Date of work: 3/27/70

Set a 2 inch galvanized iron pipe 24 inches in ground, at exact corner point indicated on plat of this designated corner, with brass cap marked, from which:

Libby
Airport
COR 2
1970
SJS 2532 S

A 6 in. Ponderosa Pine bears S. 29° W. - 42 lks - mkd rm

A 9 in. Ponderosa Pine bears N. 81½° W. - 47 lks - mkd rm

Location, attention and bearing tree signs were posted at the corner.

SKETCH, WITH COURSE AND DISTANCE TO ADJACENT CORNERS IF DETERMINED IN THIS SURVEY. (MAY SKETCH OR PASTE REPRODUCTION ON REVERSE SIDE.)

Plat attached to reverse side of recordation form for corner no. 2 of survey of Libby Airport.

Surveyor's Seal

I, A. R. TRENKLE
certify that the information shown herein is true and correct.

A. R. Trenkle
Signature of Ground Party Chief

I, STANLEY J. SKOUSEN
certify that I have carefully performed or reviewed the work done on the diagrammed corner as reported on this recordation form and approve the same.

Stanley J. Skousen
Signature of Surveyor

DIAGRAM OF CORNER:

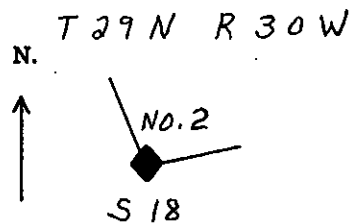

◆ = Corner recorded on the sheet

2532 S
Registration Number

Office of Clerk and Recorder, County of Lincoln

This "corner record" was filed for record on the 6th day of May 1970, was noted on the cross-index plat and is assigned page No. 184, in book No. 1

ELEANOR L. VAUGHN, By: Mar. Watson
County Official Deputy

Cross Index No. 12-3 T. 29 R. 30 Mer.