

PLSS CORNER RECORDATION

CORNER S1/4 CORNER SEC. 13 T. 29N, R. 30W, P.M.M., LINCOLN COUNTY

FOUND: NO EVIDENCE OF ORIGINAL WOOD POST OR BEARING TREES
 15° FIR BEARS N30°E, 26.40' WITH VISIBLE SCRIBE 1/4 S.
 21° FIR BEARS N16°E, 39.60' SCRIBE OVERGROWN.
 23° PINE BEARS S26°W, 8.0' SCRIBE OVERGROWN.

MAINTENANCE: REMOVED SMALL TREES FROM CORNER AREA.
 SET 5 FOOT STEEL POST 1 FOOT NORTH OF CORNER.
 PAINTED RED BANDS ON BT'S AND ATTACHED BEARING TREE TAGS.

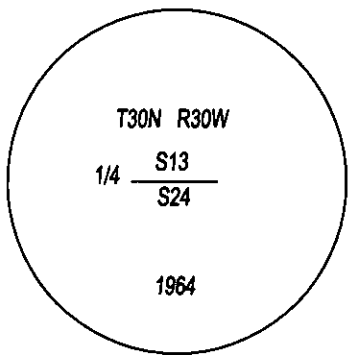
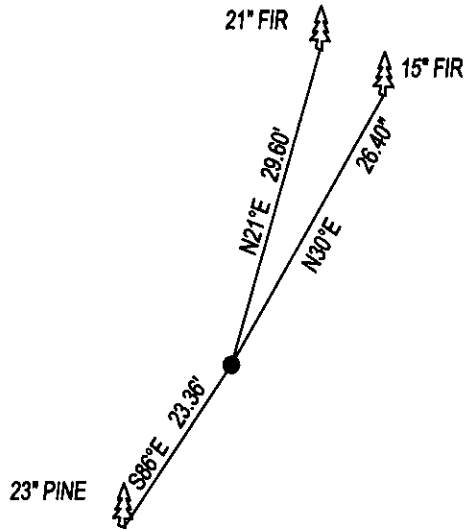

SKETCH OF CORNER

CERTIFICATION

I, DAN CROFT
 CERTIFY THE INFORMATION SHOWN HEREIN IS TRUE AND CORRECT.

SIGNATURE GROUND PARTY CHIEF

I, MARC J. CARSTENS
 CERTIFY THAT THIS CORNER RECORD CORRECTLY REPRESENTS WORK
 PERFORMED BY ME OR UNDER MY DIRECTION IN COMPLIANCE WITH THE
 "CORNER RECORDATION ACT" (70-22-101, ET SEQ., M.C.A.)



SIGNATURE OF SURVEYOR & SEAL

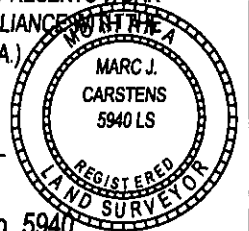

12-29-2014

LIC. No. 5940

DATE

CARSTENS SURVEYING

EMPLOYER

OFFICE OF CLERK AND RECORDER, COUNTY OF LINCOLN. THIS "CORNER RECORD" WAS FILED FOR RECORD ON _____ WAS NOTED ON THE CROSS-INDEX PLAT AND IS ASSIGNED PAGE NO. _____, IN BOOK NO. _____

COUNTY OFFICIAL

CROSS INDEX NO. N-23 T. 29N

ADOPTED NOVEMBER 7, 2012, MONTANA BOARD OF

255282 BOOK: CCR CC&R'S PAGE: 12184 Pages: 1

STATE OF MONTANA LINCOLN COUNTY

RECORDED: 12/31/2014 10:25 KOI: CC&R'S

TAMMY D. LAUER CLERK AND RECORDER

FEE: \$0.00

BY: 

FOR: CARSTENS LAND SURVEYING P.O. BOX 1374, POLSON, MONTANA

SEC. 13

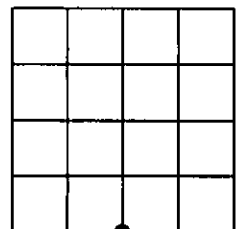

● CORNER THIS SHEET