

CERTIFIED CORNER RECORDATION

Corner SW CORNER SEC.27 T. 29N R. 30W P.M.M. County LINCOLN

FOUND: 3 1/4" BRASS CAP STAMPED AS SHOWN, FROM WHICH:
 9" TAMARACK BEARS N77°E 3.70' SCRIBE OVERGROWN.
 11" TAMARACK BEARS S77°E 24.40' SCRIBE OVERGROWN.
 12" TAMARACK BEARS S11°W 19.0' SCRIBE OVERGROWN.
 13" FIR BEARS N70°W 35.60' SCRIBE OVERGROWN.

MAINTENANCE: REMOVED BLOW DOWNS AND BRUSH FROM CORNER AREA.

ATTACHED BT TAGS AND PAINTED A RED 6" BAND AND SCRIBE RED
 SET 5 FOOT STEEL POST TWO FEET NORTH OF CORNER.

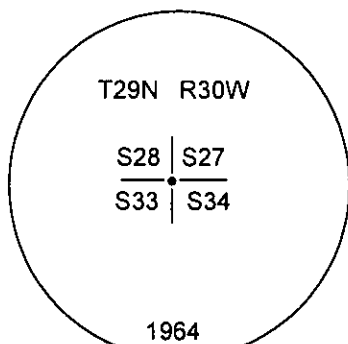
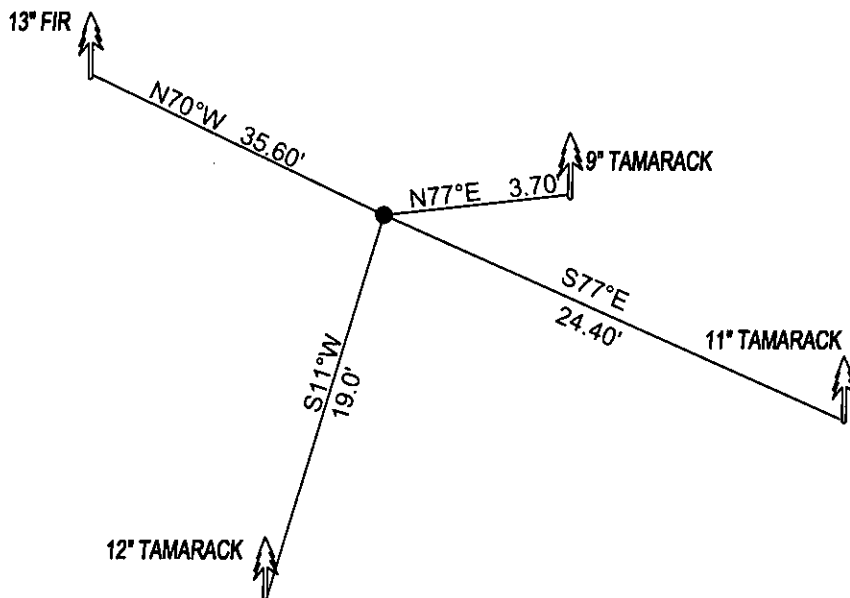

SKETCH OF CORNER

CERTIFICATION

I, DAN CROFT

certify the information shown herein is true and correct.

Signature Ground Party Chief

I, MARC J. CARSTENS

certify that this Corner Record correctly represents work performed by me or under my direction in compliance with the "Corner Recordation Act" (70-22-101, et seq., M.C.A.)

Signature of Surveyor & Seal



Date: 08-2010 Reg. No. 5940 LS

Employer: CARSTENS LAND SURVEYING

Office of Clerk and Recorder, County of LINCOLN This "corner

record" was filed for record on 227952 BOOK: CCR CC&R'S PAGE: 11537 Pages: 1

was noted on the cross-index plat an STATE OF MONTANA LINCOLN COUNTY

book No. TAMMY D. LAUER CLERK AND RECORDER

FEE: \$0.00 BY: Jeanne Danner Deputy

TO: CARSTENS LAND SURVEYING P.O. BOX 1374, POLSON, MONTANA

Cross Index No. V-13 T. 29N R. 30W PMM

Adopted July 1, 1981, Montana Board of Professional Engineers & Land Surveyors

Sec. 27

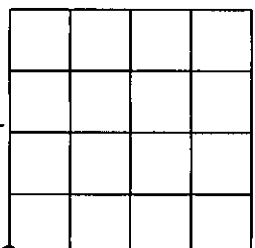

• corner this sheet