

# CERTIFIED CORNER RECORDATION

Corner W1/4 CORNER SEC.27 T. 29N R. 30W P.M.M. County LINCOLN

**FOUND:** ORIGINAL STONE IN MOUND OF STONE 14x4x8" ABOVE GROUND WITH 1/4 ON WEST, NO EVIDENCE OF BEARING TREES.

**MAINTENANCE:** REMOVED BRUSH FROM CORNER AREA AND REINFORCED MOUND AROUND CORNER, FROM WHICH:  
 NEW BEARING TREE'S  
 18" PINE BEARS N90°E, 28.0', MARKED RM  
 9" FIR BEARS S07°W, 8.0' MARKED RM  
 ATTACHED BT TAGS AND PAINTED A RED 6" BAND AND SCRIBE RED  
 SET 5 FOOT STEEL POST 4 FEET NORTH AND 4 FEET SOUTH OF CORNER.

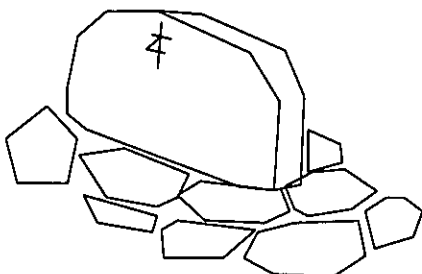
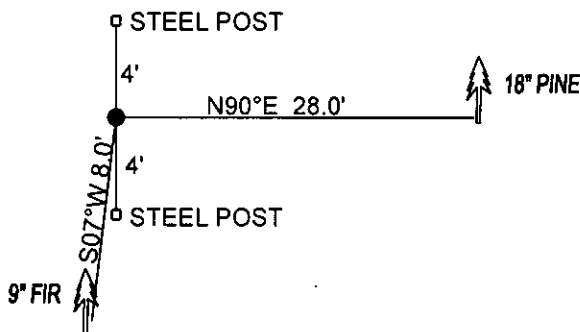

SKETCH OF CORNER

CERTIFICATION

I, DAN CROFT

certify the information shown herein is true and correct.

Signature Ground Party Chief

I, MARC J. CARSTENS

certify that this Corner Record correctly represents work performed by me or under my direction in compliance with the "Corner Recordation Act" (70-22-101, et seq., M.C.A.)

*(Signature)*

Signature of Surveyor & Seal



Date: 08-2010 Reg. No. 5940 LS

Employer: CARSTENS LAND SURVEYING

Office of Clerk and Recorder, County of LINCOLN . This "corner

record" was filed for record on \_\_\_\_\_

was noted on the cross-index plat at \_\_\_\_\_

book No. \_\_\_\_\_

227950 BOOK: CCR CC&R'S PAGE: 11535 Pages: 1

STATE OF MONTANA LINCOLN COUNTY

RECORDED: 08/26/2010 10:15 KOI: CC&R'S

TAMMY D. LAUER CLERK AND RECORDER

FEE: \$0.00

BY *(Signature)*

TO: CARSTENS LAND SURVEYING P.O. BOX 1374, POLSON, MONTANA

Cross Index No. T-13 T. 29N R. 30W PMM

Sec. 27

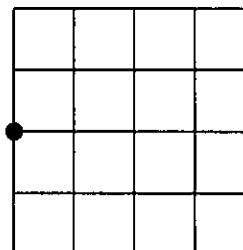

• corner this sheet