

UNIFIED LAND CORNER RECORD

1/4 COR 34/35 T29N R29W LINCOLN COUNTY, MONTANA

DESCRIPTION OF CORNER EVIDENCE FOUND, AND ORIGINAL RECORD (IF KNOWN)

ORIGINAL

1898 GLO NOTES VOL. 3418 PAGE 21

CORNER DESC.: GRANITE STONE 16" x 8" x 6", 11" IN GROUND MKD 1/4 ON W.

WITNESS MARKS: 24" TAMARACK BEARS N 33°-40'W, 39 LKS. MKD 1/4 S 34 BT 10" FIR BEARS S68°E, 35 LKS MKD 1/4 S 35 BT

FOUND: THE TWO BEARING TREES WERE FOUND AS DESCRIBED. OF SEVERAL BOULDERS IN IMMEDIATE VICINITY NONE BORE ANY DISCERNABLE MARKINGS. FOUND HOLE IN GROUND WHICH CHECKED OUT WITH B.T.S ON BEARINGS AND CALLED DIST.

DESCRIPTION OF MONUMENT AND ACCESSORIES ESTABLISHED TO PERPETUATE THE ORIGINAL LOCATION OF THIS CORNER:

SET 2" PIPE WITH BRASS CAP INTO ORIGINAL HOLE. TOP OF BRASS CAP WAS LEFT PROTRUDING ABOVE GROUND 1-1/2'. A CARIN OF ROCKS WERE PILED AROUND PIPE AND PAINTED YELLOW BRASS CAP WAS STAMPED.

Date of work: 20 May 66

1/4 COR 34/35
T29N, R29W
C of E

SKETCH, WITH COURSE AND DISTANCE TO ADJACENT CORNERS IF DETERMINED IN THIS SURVEY. (MAY SKETCH OR PASTE REPRODUCTION ON REVERSE SIDE.)

RECOVERED 24" TAMARACK MKD 1/4 S 34 BT

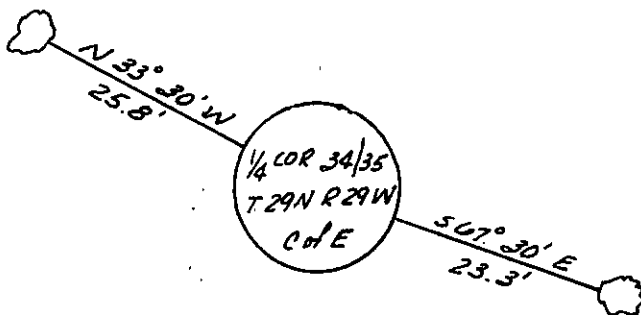

RECOVERED 10" FIR MKD 1/4 S35 BT

DIAGRAM OF CORNER:

Surveyor's Seal

I, LAVERNE L. ESTES certify that the information shown herein is true and correct

Laverne L. Estes
Signature of Ground Party Chief

N.

34/35

A STD. B.C. STAMPED
1/4 COR 34/35
T29N R29W
C of E

I, LAWRENCE A. SIGNANI certify that I have carefully performed or reviewed the work done on the diagrammed corner as reported on this recordation form and approve the same.

Lawrence A. Signani
Signature of Surveyor

= Corner recorded on the sheet



11422
Registration Number

Office of Clerk and Recorder, County of _____

This "corner record" was filed for record on the 2nd day of May 1969, was noted on the cross-index plat and is

assigned page No. 123, in book No. 1

Edward L. ...
County Official