

CERTIFIED CORNER RECORDATION

Corner N1/4 SEC. 13 T. 29N R. 29W P.M.M. County LINCOLN

GLO RECORD: SET A SLATE STONE 18x8x6, 12 INCHES INTO THE GROUND WITH 1/4 ON NORTH, FROM WHICH:
18" FIR BEARS S31°50'E 40.92' SCRIBED 1/4 S13 BT.
10" FIR BEARS N3°40'W 108.90' SCRIBE 1/4 S12 BT.

FOUND: ORIGINAL STONE NO 1/4 COULD BE FOUND, FROM WHICH:
27" FIR BEARS S32°E 40.90' WITH SOME SCRIBE.

MAINTENANCE: REMOVED BRUSH FROM CORNER AREA. SET 5 FOOT STEEL POSTS 2 FEET
EAST AND 2 FEET WEST OF CORNER.
ATTACHED BT TAGS AND PAINTED A RED 6" BAND AND SCRIBE RED

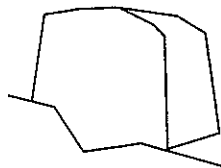
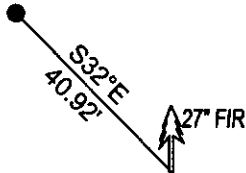

SKETCH OF CORNER

CERTIFICATION

I, DAN CROFT
certify the information shown herein is true and correct.

Signature Ground Party Chief

MARC J. CARSTENS
certify that this Corner Record correctly represents work
performed by me or under my direction in compliance with
the "Corner Recordation Act" (10-22-101, et seq., M.C.A.)

[Signature]
Signature of Surveyor & Seal



Date: 09-2011 Reg. No. 5940 LS

Employer: CARSTENS LAND SURVEYING

Office of Clerk and Recorder, County of LINCOLN. This "corner

record" was filed for record on 234772 BOOK: CCR CC&R'S. PAGE: 11908 Pages: 1

was noted on the cross-index plat RECORDED: 09/20/2011 9:55 KOI: CC&R'S

book No. TAMMY D. LAUER CLERK AND RECORDER

FEE: \$0.00 BY: [Signature]
TO: CARSTENS LAND SURVEYING P.O. BOX 1374, POLSON, MONTANA

Cross Index No. J-23 T. 29N R. 29W PMM

Adopted July 1, 1981, Montana Board of Professional Engineers & Land Surveyors

Sec. 13

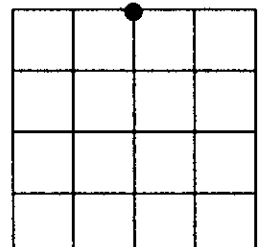

• corner this sheet