

CERTIFIED CORNER RECORDATION

Corner S 1/4 S23 T. 29 N. R. 29 W. P.M.M. Lincoln County

I. Record: 1898 original GLO survey by Paul S. Bickel: Set a slate stone 20x10x4 ins. 15 ins. in the ground, marked 1/4 on the N. face from which:

A fir, 18 ins. diam., bears N. 10° W., 30 lks. dist., (19.80 ft.), mkd. 1/4 S 23 BT.
A tamarack, 10 ins. diam., bears S. 10° 18' E., 36 lks. dist., (23.70 ft.), mkd 1/4 S 26 BT.

1965 BLM Remonumentation : Set a iron post, 30 ins. long, 2 1/2 ins. diam., 24 ins. in the ground with brass cap from which:

A larch, 14 ins. diam., bears S. 27° E., 36 lks. dist., (23.76 ft.) with over grown blaze.
A stump, 18 ins. diam., bears N. 10° W., 30 lks. dist., (19.80 ft.) with visible mks.
A larch, 17 ins. diam., bears N. 43° E., 28 lks. dist., (18.48 ft.) mkd. 1/4 S23 BT.

II. Found: A 2 1/2 ins. diam. iron pipe with a 3 1/4 ins. diam. BLM brass cap 4 ins. above ground and firmly set from which:

A larch, 20 ins. diam., bears N. 43° E., 18.50 ft. dist., with overgrown blaze.
A larch, 16 ins. diam., bears S. 27° E. 23.80 ft. dist. with overgrown blaze.
A fir stump, 18 ins. diam., bears N. 10° W., 20.00 ft. dist., with visible scribes.

III. Perpetuation:

Painted faces and 6 in. wide red bands to all bearing trees and attached Land Survey Monument and Bearing Tree signs.

Set a steel post on line 3 ft. west with attached Property Line and Survey Monument stickers.

Magnetic declination: 18° East

Equipment used: Hand compass and loggers tape

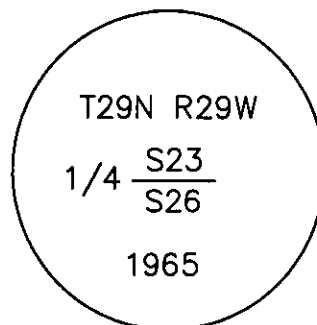

Kootenai Surveyors Inc., 314 California Av., Libby, MT. 59923 (406) 293-4354

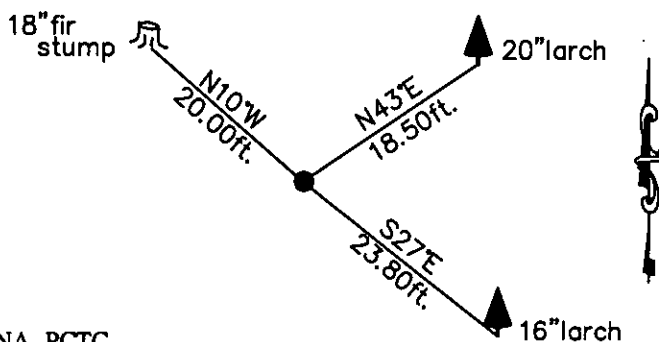

ARIANNA-PCTC

SKETCH OF CORNER

CERTIFICATION

I, Levi Powell
certify the information shown herein is true and correct.

Levi Powell
Signature Ground Party Chief

I, Alvah F. Hughes
certify that this Corner Record correctly represents work performed by me or under my direction in compliance with the "Corner Recordation Act" (70-22-101, et seq., M.C.A.)

Alvah F. Hughes
Signature of Surveyor & Seal

Date: 11/03/2008 Reg. No. 7322-LS

Employer: Kootenai Surveyors Inc.

Office of Clerk and Recorder, County of Lincoln This "corner

record" was filed for 215764 BOOK: CCR CC&R'S PAGE: 11286 Pages: 1

was noted on the STATE OF MONTANA LINCOLN COUNTY

book No. RECORDED: 12/01/2008 2:20 KOI: CC&R'S

TAMMY D. LAUER CLERK AND RECORDER

FEE: \$0.00

BY: Francis Dennis

TO: KOOTENAI SURVEYORS INC. P.O. BOX 393, LIBBY, MT 59923

Cross Index No. R 19 T. 29N R. 29W P.M., MT

Adopted July 1, 1981, Montana Board of Professional Engineers & Land Surveyors

Sec.23

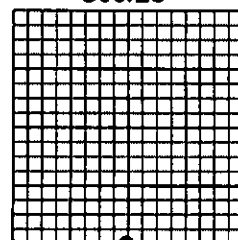

• corner this sheet