

CERTIFIED CORNER RECORDATION

Corner E 1/16 sec 4 T 29 N. R. 29 W. P.M.M. LINCOLN County

I. Record: No previous record.

II. Found: No evidence found.

III. Perpetuation: At the calculated position from survey, set a 3 1/4 in. diam. aluminum cap on 5/8 in. diam. rebar 24 ins. long 21 ins. in the ground, marked as shown:

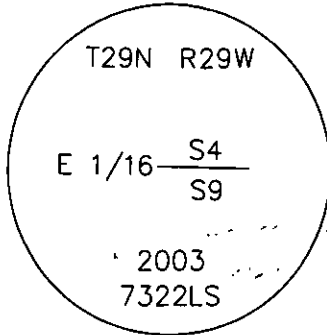

From which:

- A Ponderosa pine, 28 ins. diam., bears N17°49'E., 57.80 ft. dist., scribed E 1/16 S4 BT.
- A Ponderosa pine, 16 ins. diam., bears S17°34'E., 96.60 ft. dist., scribed E 1/16 S4 BT.

Painted 6" wide red bands around all bearing trees and attached Bearing tree and Land Survey Monument signs.

Magnetic declination: 20° East assumed

Equipment used: Hand compass and loggers tape

Kootenai Surveyors Inc., 314 California Av., Libby, MT. 59923 (406) 293-4354

Alder-Buck - PCTC

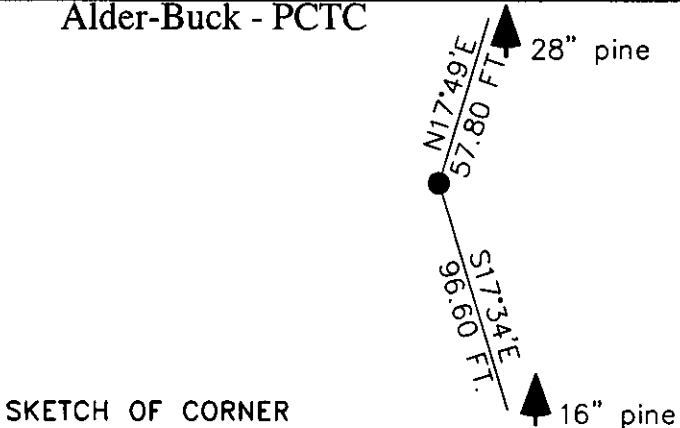

SKETCH OF CORNER

CERTIFICATION

I, Pete Landis
certify the information shown herein is true and correct.

Signature Ground Party Chief
 I, Alvah F. Hughes
 certify that this Corner Record correctly represents work performed by me or under my direction in compliance with the "Corner Recordation Act" (70-22-101, et seq., M.C.F.A.)
Alvah F. Hughes
 Signature of Surveyor & Seal

Date: 12/4/03 Reg. No. 7322-LS
 Employer: Kootenai Surveyors Inc.

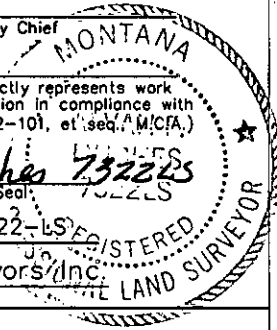

Office of Clerk and Recorder, County of Lincoln. This "corner

record" was filed for recd 190123 BOOK: CCR CC&R'S PAGE: 10905 Pages: 1

was noted on the cross-RECORDED: 12/06/2005 9:27 KOI: CC&R'S
 book No. CORAL M. CUMMINGS CLERK AND RECORDER

FEE: \$0.00 BY: Jeanne Denny Deputy
 TO: AL HUGHES-SURVEYOR P.O. BOX 393, LIBBY MT 59923

Cross Index No. E 12 12 T. 29N. R. 29W. P.M., MT

Adopted July 1, 1981, Montana Board of Professional Engineers & Land Surveyors

Sec. 4

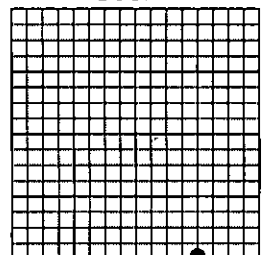

• corner this sheet