

CERTIFIED CORNER RECORDATION

Corner E 1/4 cor. of Sec. 4 T 29 N. R. 29 W. P.M.M. LINCOLN County

I. Record: 1898 GLO survey by Bickel: Set a stone 24x12x3 ins., 18 ins. in the ground, from which:

A pine, 16 ins. in diameter, bears N.37°E., 28 lks. dist. (18.48 ft.).

A pine, 8 ins. in diameter, bears N.67°W., 51 lks. dist. (33.66 ft.).

1966 BLM Remon: Set a 3 1/4 in. diam. brass cap from original bearing trees.

II. Found: 3 1/4 in. diam. BLM BC on 2 1/2 in. diam. iron pipe 4 ins. above ground, as shown below, from which:

A Ponderosa pine stump, 15 ins. diam., bears N.42°E., 17.90 ft. dist., visible scribe.
(Original GLO)

A Ponderosa pine, 19 ins. diam., bears N.76°W., 33.10 ft. dist., visible scribe. (Original GLO)

III. Perpetuation:

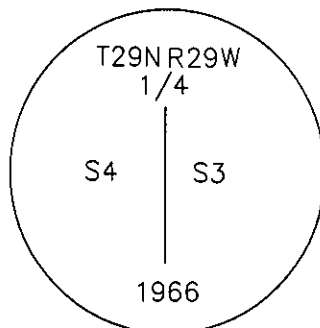

From which:

A Douglas fir, 11 1/2 ins. in diameter, bears N.37°E., 40.00 ft. dist., scribed 1/4 S3 BT.

Painted 6 in. wide red bands around all BT's and attached Bearing tree and Land Survey Monument signs.

Magnetic declination: 18° East assumed

Equipment used: Hand compass and loggers tape

Kootenai Surveyors Inc., 314 California Av., Libby, MT. 59923 (406) 293-4354

Alder-Buck - PCTC

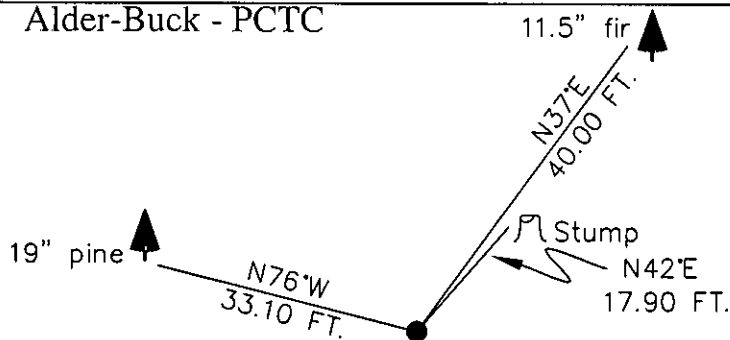

SKETCH OF CORNER

CERTIFICATION

I, Kenneth Kern
certify the information shown herein is true and correct.

Kenneth Kern
Signature Ground Party Chief

I, Alvah F. Hughes
certify that this Corner Record correctly represents work performed by me or under my direction in compliance with the "Corner Recordation Act" (70-22-101, et seq., M.C.A.).

Alvah F. Hughes
Signature of Surveyor & Sealer

Date: 1/06/2005 Reg. No. 7322-LS

Employer: Kootenai Surveyors Inc.

Sec. 4

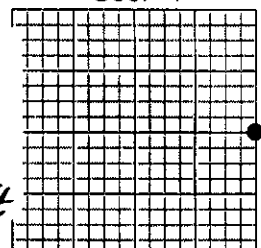

• corner this sheet

Office of Clerk and Recorder, County of Lincoln This "corner

record" was filed for record on 188872 BOOK: CCR CC&R'S PAGE: 10855 Pages: 1

was noted on the cross-index STATE OF MONTANA LINCOLN COUNTY

book No. RECORDED: 10/18/2005 8:36 KOI: CC&R'S

CORAL M. CUMMINGS CLERK AND RECORDER

FEE: \$0.00

BY: [Signature]

TO: KOOTENAI SURVEYORS INC. P.O. BOX 393, LIBBY, MT 59923

Cross Index No. C 13 T. 29N. R. 29W. P.M., MT

Adopted July 1, 1981, Montana Board of Professional Engineers & Land Surveyors



Handwritten text, possibly a signature or date, located in the bottom left corner of the page.