

CERTIFIED CORNER RECORDATION

Corner N 1/4 cor. of Sec. 4 T 29 N. R. 29 W. P.M.M. LINCOLN County

I. Record: 1898 GLO survey by Bickel: Set a stone 20x12x8 ins., 15 ins. in the ground from which:

A fir, 8 ins. diam., bears S.71°50'E., 33 lks. dist. (21.78 ft.).

A fir, 8 ins. diam., bears N.41°50'W., 20 lks. dist. (13.20 ft.).

1966 - BLM Remon: Set a 3 1/4 in. diam. brass cap from original bearing trees.

II. Found: 3 1/4 in. diam. BLM BC with 2 1/2 in. diam. iron pipe in rock mound 4 ins. above ground, from which:

A Douglas fir stump, 21 1/2 ins. diam., bears N.40°E., 13.90 ft. dist., with visible scribe.

(Record N41°50'W, 20 lks., 13.20 ft.)

A Douglas fir, 14 1/2 ins. diam., bears S.71°E., 21.78 ft. dist., with visible scribe.
(Original GLO)

III. Perpetuation:

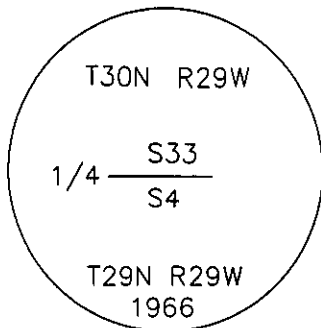

From which:

A Ponderosa pine, 12 ins. diam., bears N.81°E., 49.90 ft. dist. scribed 1/4 S33 BT.

Painted 6 in. wide red bands around all Bearing trees and attached Bearing tree and Land Survey Monument signs.

Magnetic declination: 18° East assumed

Equipment used: Hand compass and loggers tape

Kootenai Surveyors Inc., 314 California Av., Libby, MT. 59923 (406) 293-4354

Alder-Buck - PCTC

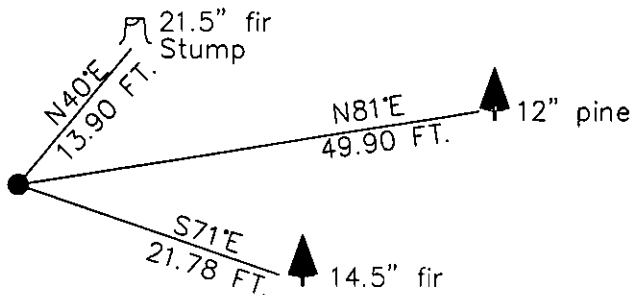

SKETCH OF CORNER

CERTIFICATION

I, Kenneth Kern
certify the information shown herein is true and correct.

Kenneth Kern
Signature Ground Party Chief

I, Alvah F. Hughes
certify that this Corner Record correctly represents work performed by me or under my direction in compliance with the "Corner Recordation Act" (70-22-101, et. seq., M.C.A.)

Alvah F. Hughes
Signature of Surveyor & Seal

Date: 1/06/2005 Reg. No. 7322-LS

Employer: Kootenai Surveyors Inc.

ALVAH F. HUGHES
7322-LS
REGISTERED

Office of Clerk and Recorder, County of Lincoln This "corner

record" was filed for recd 188871 BOOK: CCR CC&R'S PAGE: 10854 Pages: 1

was noted on the cross- STATE OF MONTANA LINCOLN COUNTY RECORDED: 10/18/2005 8:35 KOI: CC&R'S

book No. CORAL M. CUMMINGS CLERK AND RECORDER

FEE: \$0.00

BY: *Kenneth Kern*

TO: KOOTENAI SURVEYORS INC. P.O. BOX 393, LIBBY, MT 59923

Cross Index No. A 11 T. 29N. R. 29W. P.M., MT

Adopted July 1, 1981, Montana Board of Professional Engineers & Land Surveyors

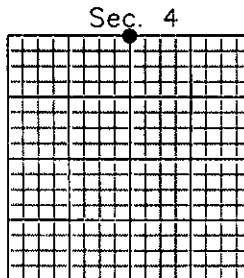

• corner this sheet

[Faint circular stamp]