

CERTIFIED CORNER RECORDATION

Corner W 1/4 cor. of Sec. 4 T 29 N. R. 29 W. P.M.M. LINCOLN County

I. Record: 1898 GLO survey by Bickel: Set a stone 16x12x8 ins. 11 ins. in the ground from which:

A Tamarack 10 ins. diam. bears N68°30'E., 83 lks. dist. (54.78 ft.)
A pine 16 ins. diam. bears S76°30'W., 17 lks. dist. (11.22 ft.)

1964 BLM Remon: Set a 3 1/4 in. diam. brass cap from found original stone and bearing trees from which:

A stumphole, bears N68°30'E., 83 lks.(54.78 ft.) dist.
A pine, 24 ins. diam., bears S86°30'W., 20 lks.(13.20 ft.) dist.
A fir, 8 ins. diam., bears N60°E., 16 lks.(10.56 ft.) dist.

II. Found: A 3 1/4 in. diam. BLM brass cap set firmly in ground at ground level, from which:

A Ponderosa pine, 26 ins. diam. bears S.88°W., 13.50 ft. dist. (Original GLO)
A Douglas fir, 12 ins. diam. bears N.58°E., 10.80 ft. dist. (1964 Remon)

III. Perpetuation:

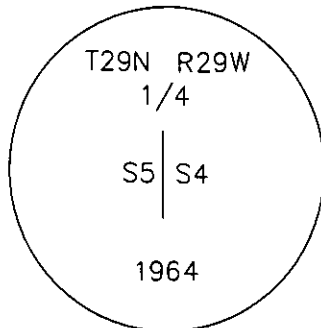

Painted 6 in. wide red bands around both bearing trees and attached Land Survey Monument signs.

Magnetic declination: 20° East assumed

Equipment used: Hand compass and loggers tape

Kootenai Surveyors Inc., 314 California Av., Libby, MT. 59923 (406) 293-4354

Alder-Buck - PCTC

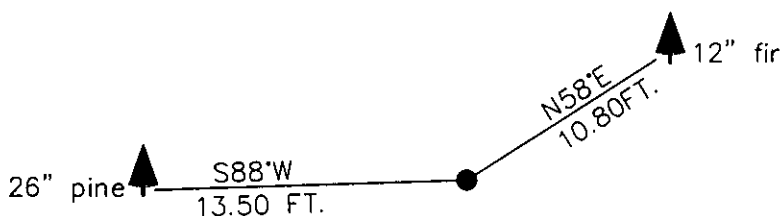

SKETCH OF CORNER

CERTIFICATION

I, Kenneth Kern
certify the information shown herein is true and correct.

Kenneth Kern
Signature Ground Party Chief

I, Alvah F. Hughes
certify that this Corner Record correctly represents work performed by me or under my direction in compliance with the "Corner Recordation Act" (76-22-101, et seq., M.C.A.)

Alvah F. Hughes
Signature of Surveyor & Seal

Date: 1/06/2005 Reg. No. 7322

Employer: Kootenai Surveyors Inc.

Office of Clerk and Recorder, County of Lincoln This "corner

record" was filed for record

was noted on the cross-in-

book No. _____

188868 BOOK: CCR CC&R'S PAGE: 10851 Pages: 1

STATE OF MONTANA LINCOLN COUNTY

RECORDED: 10/18/2005 8:32 KOI: CC&R'S

CORAL M. CUMMINGS CLERK AND RECORDER

FEE: \$0.00

BY: Deanne D. Davis

TO: KOOTENAI SURVEYORS INC. P.O. BOX 393, LIBBY, MT 59923

Cross Index No. C 09 T. 29N. R. 29W. P.M., MT

Adopted July 1, 1981, Montana Board of Professional Engineers & Land Surveyors

\\Manon\etl\Land Projects 3\Corner Rec\Buck-Alder.dwg, 10/13/2005 2:52:41 PM, Auto HP LaserJet 4 Plus on ALVAH

Sec. 4

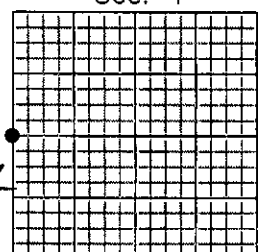

• corner this sheet

SECRET