

INSTRUCTIONS

1. Original and/or subsequent record used to evaluate the corner position.
2. Description of evidence found, note discrepancies in the record, state method of establishing lost or obliterated corners.
3. Description of monument and accessories set to perpetuate the corner position.
4. Sketch of corner, show all pertinent data which can best be shown in a sketch example, corner marking, topography ties, position of accessories, etc.
5. Certification must be signed and sealed by Land Surveyor registered in the State of Montana.
6. Fill in Cross Index & Section Diagram at bottom of sheet.

CERTIFIED CORNER RECORDATION

Corner of Secs. 26, 27, 34, & 35 T. 29 N., R. 28 W., P.M.M. Lincoln County

I. 1903 original G.L.O. record by George A. Fessenden and Ranney Y. Lyman: "Set a slate stone, 18 X 10 X 8 ins., 12 ins. in the ground, for cor. of secs. 26, 27, 34 and 35, marked with 1 notch on S. and 2 notches on E. edge; from which

- A tamarack, 6 ins. dia., bears N49° E, 20 lks. dist., marked T29N R28W S26 BT.
- A fir, 12 ins. dia., bears S69° 30' E, 27 lks. dist., marked T29N R28W S35 BT.
- A fir, 12 ins. dia., bears S67° 30' W, 17 lks. dist., marked T29N R28W S34 BT.
- A tamarack, 14 ins. dia., bears N40° W, 18 lks. dist., marked T29N R28W S27 BT.

II. Found a stone, 17 X 9 x 6 ins., firmly set, 13 ins. in the ground, mkd. 1 notch on S. edge and marks on E. edge are obliterated due to fractures, from which

- A larch snag, 9 ins. dia., bears N44° E, 12.1 ft. (18.3 lks.) dist., healed face.
- A subalpine fir, 16 ins. dia., bears S68° W, 11.7 ft. (17.7 lks.) dist., healed face.
- A larch, 19 ins. dia., bears N40° W, 11.7 ft. (17.7 lks.) dist., healed face.

III. At the corner point, set a 2 1/2 ins. dia. aluminum pipe, 30 ins. long, 25 ins. in the ground with a 3 1/4 ins. diam. aluminum cap, marked as shown:

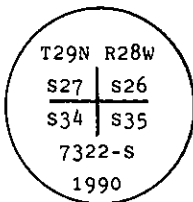

Bury original stone alongside new monument and raise a collar of stone around pipe.

Established two new bearing trees:

- A spruce, 12 ins. dia., bears N27° E, 5.5 ft. dist., mkd. T29N R28W S26 BT.
- A larch, 8 ins. dia., bears S32° E, 17.8 ft. dist., mkd. T29N R28W S35 BT.

Painted a red band around each bearing tree and attached Land Survey Monument and Bearing Tree signs. Magnetic Declination: 20° East.

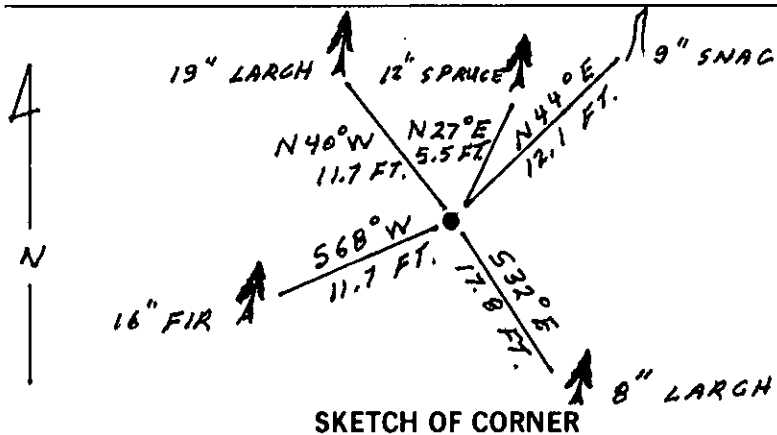

CERTIFICATION

I, Kevin Todd  
 certify the information shown herein is true and correct.  
Kevin Todd  
 Signature Ground Party Chief

I, Alvah F. Hughes  
 certify that this Corner Record correctly represents work performed by me or under my direction in compliance with the Montana Recordation Act" (70-22-101, et seq., M.C.A.)  
Alvah F. Hughes  
 Signature of Surveyor

Date: 1/2/91 Reg. No. 7322  
 Employer: U.S. FOREST SERVICE

Office of Clerk and Recorder, County of Lincoln. This "corner record" was filed for record on 1-10-91 was noted on the cross-index plat and is assigned page No. 4498, in book No. \_\_\_\_\_

Coral McCummings by Bill Busch  
 County Official

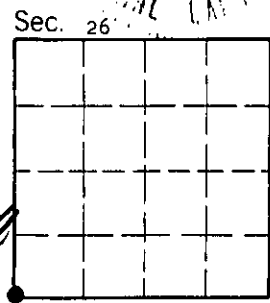

V-17 29 N 28 W  
 Cross Index No. \_\_\_\_\_ T. \_\_\_\_\_ R. \_\_\_\_\_ PMM • - corner this sheet