

INSTRUCTIONS

1. Original and/or subsequent record used to evaluate the corner position.
2. Description of evidence found, note discrepancies in the record, state method of establishing lost or obliterated corners.
3. Description of monument and accessories set to perpetuate the corner position.
4. Sketch of corner, show all pertinent data which can best be shown in a sketch example, corner marking, topography ties, position of accessories, etc.
5. Certification must be signed and sealed by Registered Land Surveyor in State of Montana.
6. Fill in Cross Index & Section Program at bottom of sheet.

CERTIFIED CORNER RECORDATION

Corner No. 3 U.S.M.S. No. 6496 in Sec. 24 T. 29 N. R. 28 W., P.M.M., Lincoln County.

1. 1901 Original Record:

Set a post 8 ins. square, 4 ft. long, 2 ft. deep, marked: 3-6496 for Cor. No. 3

From which: A Blazed Tamarack tree, 5 ins. in dia., marked: B.T. 3-6496 bears N. 74° 35' W. 44 ft.
A Blazed Tamarack tree, 28 ins. in dia., marked: B.T. 3-6496 bears S. 85° 10' W. 73.5 ft.

2. 8/9/83 Evidence Found:

Found a squared post broken off at ground level

From which: A 2 ft. high Tamarack Stump, 28 ins. in dia., marked: B.T. 3-6496 bears S. 85° 10' W. 73.5 ft. {scribed face lying on ground}.

3. 8/9/83 Perpetuation:

Set a 5/8 inch dia. x 24 inch long rebar with yellow PVC cap stamped: MDL 4232S in portion of post left broken off in ground.

From which: A 2 ft. high Tamarack Stump, 28 ins. in dia., marked: B.T. 3-6496 bears S. 85° 10' W. 73.5 ft. {scribed face lying on ground}.

New Tamarack, 13 ins. in dia., marked: 3 6496 BT bears S. 25° 30' W. 8.2 ft.

New Tamarack, 12 ins. in dia., marked: 3 6496 BT bears N. 37° 30' W. 21.3 ft.

Both New B.T.s marked with an "X" breast high painted red and scribed faces on New B.T.s and old scribed face also painted red.

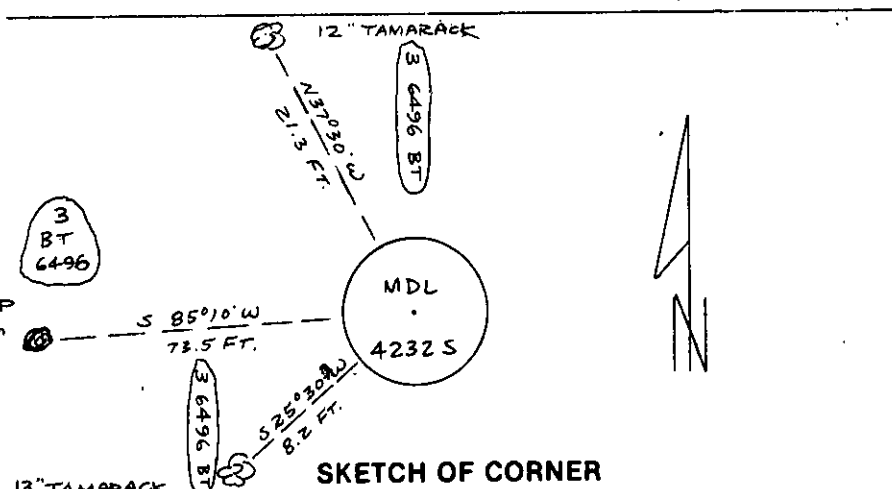

CERTIFICATION

I, Russ Hudson
certify the information shown herein is true and correct.
Russell Hudson
Signature Ground Party Chief

I, Melvin D. Lauteren
certify that this Corner Record correctly represents work performed by me or under my direction in compliance with the "Corner Recordation Act" (70-22-101, et seq., M.C.A.)
Melvin D. Lauteren
Signature of Surveyor & Seal

Date: 8/11/83 Register No. 4232S
Employer: Kootenai Engineering, Inc. St. Regis

Office of Clerk and Recorder, County of Lincoln. This "corner record" Sec. 24, T29 N, R28 W, PMM
was filed for record on the 16th day of August 19 83, was noted on the cross-index plat and
is assigned page No. 2278, in book No. Janet BF Siegel by Betty L. Conner
County Official deputy

Cross Index No. 29 R. 28 PMM

Sec. 24, T29 N, R28 W, PMM
Cor. No. 3 U.S.M.S. No. 6496
24