

CERTIFIED CORNER RECORDATION

CORNER W1/4 CORNER SEC. 18 T. 29N , R. 28W , P.M.M., LINCOLN COUNTY

GLO RECORD: SET A SLATE STONE 18x14x8, 12" INTO THE GROUND WITH 1/4 ON WEST FACE , FROM WHICH;
16" FIR BEARS S63°10'E 77 LKS SCRIBED 1/4 S18 BT.
14" TAMARACK BEARS S31°4W 53 LKS SCRIBED 1/4 S13 BT.

BLM RECORD 1966: SET A IRON POST 30" LONG 24" INTO THE GROUND WITH BRASS CAP , FROM WHICH;
6" TAMARACK BEARS N58 1/4°E 27 LKS SCRIBED 1/4 S18 BT.
7" TAMARACK BEARS N82°4W 23 LKS SCRIBED 1/4 S13 BT.

FOUND: BRASS CAP STAMPED AS SHOWN , FROM WHICH;
18" TAMARACK BEARS S31°W 35.0' WITH SOME SCRIBE.

MAINTENANCE: REMOVED BLOWDOWNS FROM CORNER AREA.

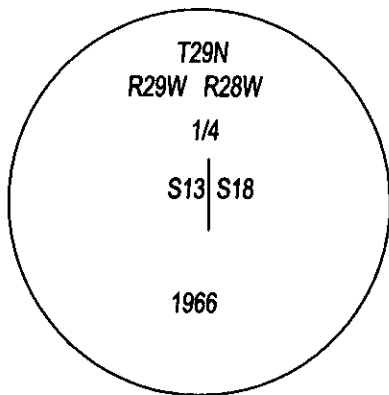
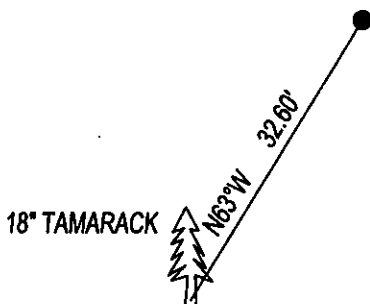

SKETCH OF CORNER

CERTIFICATION

I, DAN CROFT
CERTIFY THE INFORMATION SHOWN HEREIN IS TRUE AND CORRECT.

SIGNATURE GROUND PARTY CHIEF

I, MARC J. CARSTENS
CERTIFY THAT THIS CORNER RECORD CORRECTLY REPRESENTS WORK
PERFORMED BY ME OR UNDER MY DIRECTION IN COMPLIANCE WITH THE
"CORNER RECORDATION ACT" (70-22-101, ET SEQ., M.C.A.)

Marc J. Carstens
SIGNATURE OF SURVEYOR & SEAL

02-08-13

DATE

CARSTENS SURVEYING

EMPLOYER

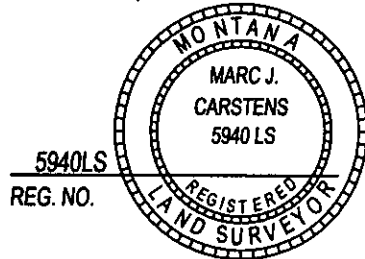

5940LS
REG. NO.

OFFICE OF CLERK AND RECORDER COUNTY OF LINCOLN
THIS CORNER 243915 BOOK: CCR CC&R'S PAGE: 12019 Pages: 1
STATE OF MONTANA LINCOLN COUNTY
AND IS ASSIGN RECORDED: 03/08/2013 9:40 KOI: CC&R'S
TAMMY D. LAUER CLERK AND RECORDER
FEE: \$0.00 BY: [Signature]
COUNTY OFFICE FOR: CARSTENS LAND SURVEYING P.O. BOX 1374, POLSON, MONTANA
CROSS INDEX NO. L-1 T. 29N , R. 28W , P.M.M.
ADOPTED JULY 1, 1981, MONTANA BOARD OF PROFESSIONAL ENGINEERS & LAND SURVEYORS

SEC. 18

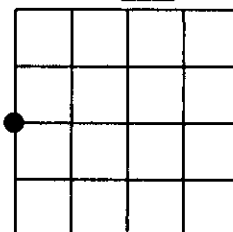

● CORNER THIS SHEET