

CERTIFIED CORNER RECORDATION

Corner E1/4 SEC. 26 T. 29N R. 28W P.M.M. County LINCOLN

GLO RECORD: SET A SLATE STONE 12x8x6, 12 INCHES INTO THE GROUND WITH 1/4 ON WEST FACE, FROM WHICH:
4" PINE BEARS SN77°15'W 11.22' SCRIBED 1/4 S326 BT.
7" PINE BEARS N52°E 19.14' SCRIBE 1/4 S25 BT.

FOUND: NO EVIDENCE OF STONE OR BEARING TREES
CORNER POSITION FALLS IN OLD SLASH PILE

MAINTENANCE: REESTABLISHED CORNER BY SINGLE PROPORTION: SET 3 1/4" ALUM CAP
STAMPED AS SHOWN, FROM WHICH:
6" LODGEPOLE BEARS N5°E, 15.0' SCRIBED 1/4 RM.
9" LARCH BEARS N52°W, 8.0' SCRIBED RM.
ATTACHED BT TAGS AND PAINTED A RED 6" BAND AND SCRIBE RED

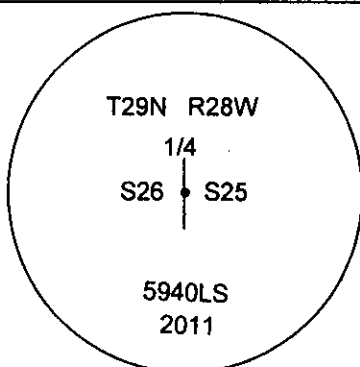
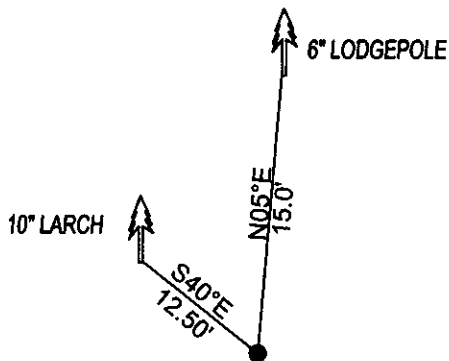

SKETCH OF CORNER

CERTIFICATION

I, DAN CROFT
certify the information shown herein is true and correct.

Signature Ground Party Chief

MARC J. CARSTENS
certify that this Corner Record correctly represents work performed by me or under my direction in compliance with the "Corner Recordation Act" (70-22-104, et seq., M.C.A.)

Signature of Surveyor & Seal

Date: 06-2011 Reg. No. 5940LS

Employer: CARSTENS LAND SURVEYING



Office of Clerk and Recorder, County of LINCOLN . This "corner

record" was filed for record
was noted on the cross-ind
book No. _____

233382 BOOK: CCR CC&R'S PAGE: 11901 Pages: 1
STATE OF MONTANA LINCOLN COUNTY
RECORDED: 06/28/2011 10:20 KOI: CC&R'S
TAMMY D. LAUER CLERK AND RECORDER
FEE: \$0.00 BY: Deanna Deane Deputy
TO: CARSTENS LAND SURVEYING P.O. BOX 1374, POLSON, MONTANA
Cross Index No. T-21 T. 29N R. 28W PMM

Adopted July 1, 1981, Montana Board of Professional Engineers & Land Surveyors

Sec. 26

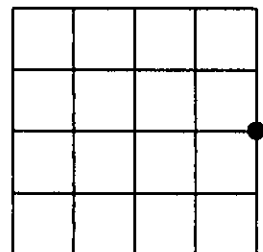

• corner this sheet