

CERTIFIED LAND CORNER RECORDATION

(REFERENCE FSH 5681.65)

DESCRIPTION OF CORNER EVIDENCE FOUND, AND ORIGINAL RECORD (IF KNOWN)

This is not a G. L. O. established corner.

DESCRIPTION OF MONUMENT AND ACCESSORIES ESTABLISHED TO PERPETUATE THE ORIGINAL LOCATION OF THIS CORNER:

Date of work: 5/23/68

Set a "T" iron, 3/4" x 18", 12" in the ground with a mound of stone surrounding, from which:

A Lodgepole Pine, 10" dbh, bears S44°35'E, 9 links, scribed S12RM

A Lodgepole Pine, 9" dbh, bears N65°31'E, 32-1/2 links, scribed S1RM

SKETCH, WITH COURSE AND DISTANCE TO ADJACENT CORNERS IF DETERMINED IN THIS SURVEY. (MAY SKETCH OR PASTE REPRODUCTION ON REVERSE SIDE.)

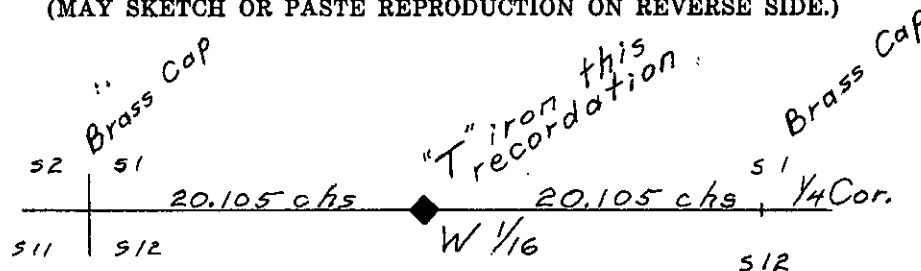

Surveyor's Seal

I, _____
certify that the information shown herein is true and correct.

Signature of Ground Party Chief

I, Robert F. Burdick
certify that I have carefully performed or reviewed the work done on the diagrammed corner as reported on this recordation form and approve the same.

Robert F. Burdick
Signature of Surveyor

DIAGRAM OF CORNER:

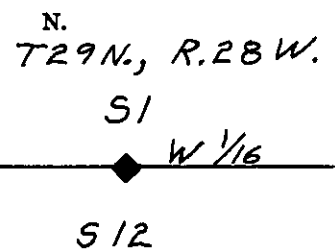

◆ = Corner recorded on the sheet

6495
Registration Number

Office of Clerk and Recorder, County of Lincoln

This "corner record" was filed for record on the 14th day of June 19 68, was noted on the cross-index plat and is

assigned page No. 114, in book No. 1

ELEANOR L. VAUGHN, By: Mae Watson
County Official Deputy.

Cross Index No. # E-22 T. 29 R. 28 Mer.