

CERTIFIED CORNER RECORDATION

Corner E 1/4 S16 T 29 N. R. 28 W. P.M.M. Lincoln County

I. Record: 1903 GLO survey by G.Fessenden and R. Lyman: Set a slate stone 18x18x6 ins., 12 ins. in the ground, for 1/4 sec. cor. marked 1/4 on W. face from which:

- A fir, 10 ins. diam., bears N.51°45'E., 10 lks. dist., (6.60 ft), mkd. 1/4 S15 BT.
- A fir, 16 ins. diam., bears S.67°45'W., 35 lks. dist. (23.10 ft), mkd. 1/4 S 16 BT.

II. Found:

- A fir stump, 11 ins. diam., bears N.51°45'E., 6.60 ft. dist. with visible scribing.
- A fir snag, 16 ins. diam. bears S.67°45'W., 23.10 ft. dist. with visible scribing.

III. Perpetuation: At a position determined from found original bearing trees, we set a Alum. pipe 2 1/2 ins. diam., 30 ins. long 24 ins. in the ground, with a 3 1/4 ins. diam. Alum. cap marked as shown below from which:

- A fir, 10 ins. diam., bears N.58°E., 26.90 ft. dist. scribed 1/4 S15 BT.
- A fir, 9 ins. diam., bears N.41°W., 17.70 ft. dist., scribed 1/4 S16 BT.
- Raise a mound of stone and earth 2 ft. diam. base 1 ft. high.
- Painted faces and 6 in. wide red bands to all bearing trees and attached Land Survey Monument and Bearing Tree signs.
- Set a steel fence post 2 ft. S. of monument.

Magnetic declination: 20° East assumed
Equipment used: Hand compass and loggers tape

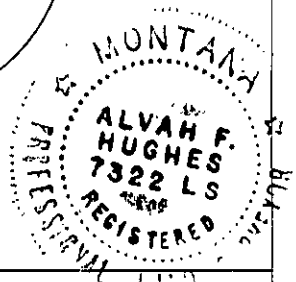
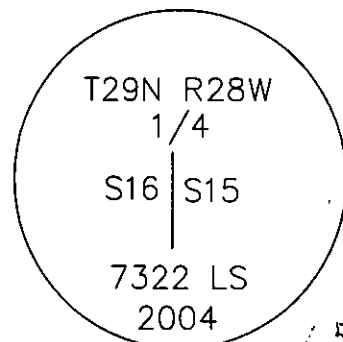

Kootenai Surveyors Inc., 314 California Av., Libby, MT. 59923 (406) 293-4354

KSI Project: East Richards - PCTC

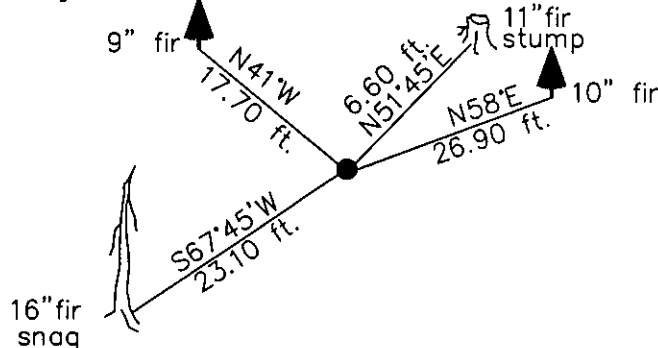

SKETCH OF CORNER

CERTIFICATION

I, Pete Landis
certify the information shown herein is true and correct.

Pete Landis
Signature Ground Party Chief

I, Alvah F. Hughes
certify that this Corner Record correctly represents work performed by me or under my direction in compliance with the "Corner Recordation Act" (70-22-101, et seq., M.C.A.)

Alvah F. Hughes 7322LS
Signature of Surveyor & Seal

Date: 12/10/2004 Reg. No. 7322-LS

Employer: Kootenai Surveyors Inc.

Office of Clerk and Recorder, County of Lincoln This "corner

record" was filed for recd 181273 BOOK: CCR CC&R'S PAGE: 10724 Pages: 1

was noted on the cross- STATE OF MONTANA LINCOLN COUNTY RECORDED: 12/14/2004 1:12 KOI: CC&R'S

book No. CORAL M. CUMMINGS CLERK AND RECORDER

FEE: \$0.00

BY: [Signature]

Cross Index No. L 13 T. 29N R. 28W P.M., MT

Adopted July 1, 1981, Montana Board of Professional Engineers & Land Surveyors

Sec. 16

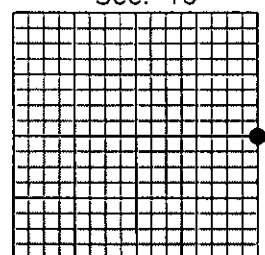

• corner this sheet