

CERTIFIED CORNER RECORDATION

Corner N 1/4 S16 T 29 N. R. 28 W. P.M.M. LINCOLN County

I. Record: 1903 GLO survey by G. Fessenden and R. Lyman: Set a slate stone 12x8x6 ins., 8 ins., in the ground, marked 1/4 on the N. face from which:

- A pine, 6 ins. diam., bears N8°30"E., 30 lks. dist. (19.80 ft) mkd. 1/4 S9 BT.
- A tamarack, 14 ins. diam., bears S2°E., 45 lks. dist. (29.70 ft) mkd. 1/4 S16 BT.

II. Found: A 30 in. diam. tamarack stump bears S.2°E., 29.70 ft. dist., with visible BT scribing.

III. Perpetuation: At a point determined from bearing and dist. from found original bearing tree stump, we set a Alum. pipe, 2 1/2 ins. diam. 30 ins. long 24 ins. in the ground, with a 3 1/4 ins. diam. Alum. cap marked as shown below from which:

- A fir 15 ins. diam., bears N.24°E., 5.50 ft. dist., scribed 1/4 S9 BT.
- A fir 15 ins. diam., bears S.40°W., 17.00 ft. dist., scribed 1/4 S16 BT.

Raise a collar of stone, 3 ft. base 1 ft. high around set monument.

Painted faces red and 6 in. wide red bands to all bearing trees and attached Land Survey Monument and Bearing tree signs.

Set a steel fence post 3 ft. E. of monument.

Magnetic declination: 20° East assumed

Equipment used: Hand compass and loggers tape

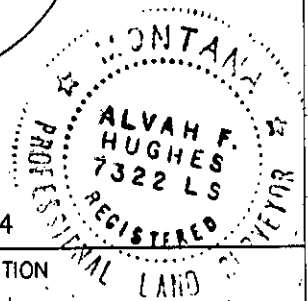
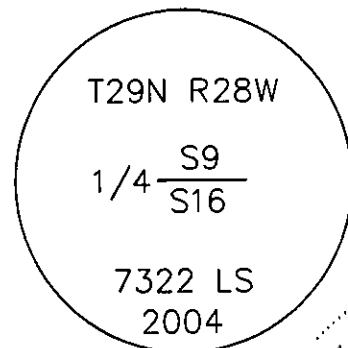

Kootenai Surveyors Inc., 314 California Av., Libby, MT. 59923 (406) 293-4354

KSI Project: East Richards - PCTC

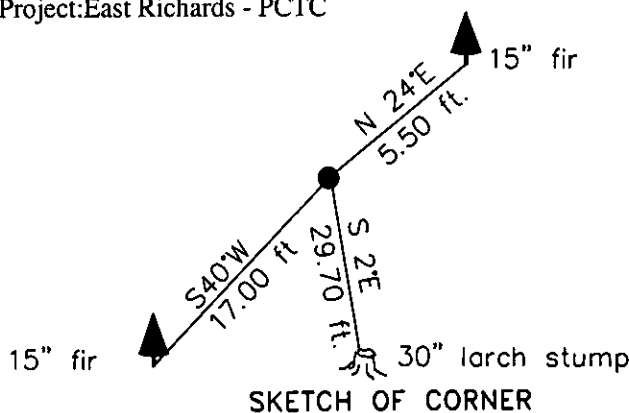

CERTIFICATION
 I, Doug Schuhknecht
 certify the information shown herein is true and correct.
[Signature]
 Signature Ground Party Chief
 I, Alva F. Hughes
 certify that this Corner Record correctly represents work performed by me or under my direction in compliance with the "Corner Recordation Act", (70-22-101, et seq., M.C.A.)
[Signature] 7322LS
 Signature of Surveyor & Seal
 Date: 12/1/2004 Reg. No. 7322-LS
 Employer: Kootenai Surveyors Inc.

Office of Clerk and Recorder, County of Lincoln This "corner record" was filed for record on 181269 BOOK: CCR CC&R'S PAGE: 10720 Pages: 1
 was noted on the cross-index STATE OF MONTANA LINCOLN COUNTY
 book No. RECORDED: 12/14/2004 1:06 KOI: CC&R'S
CORAL M. CUMMINGS CLERK AND RECORDER
 FEE: \$0.00 BY: [Signature]
 TO: FILED

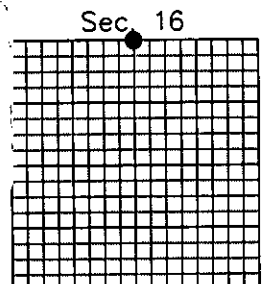

Cross Index No. J 11 T. 29N R. 28W P.M., MT

Adopted July 1, 1981, Montana Board of Professional Engineers & Land Surveyors

• corner this sheet