

CERTIFIED CORNER RECORDATION

Corner W 1/4 S16 T. 29 N. R. 28 W. P.M.M. Lincoln County

I. Record: 1903 GLO survey by G.Fessenden and R. Lyman: Set a slate stone 18x13x5 ins., 12 ins. in the ground, for 1/4 sec. cor. marked 1/4 on W face from which:

A pine, 24 ins. diam., bears N.27°30'E., 11 lks. dist., (7.26 ft), mkd. 1/4 S16 BT.
A fir, 30 ins. diam., bears S.78°30'W., 88 lks. dist. (58.08 ft), mkd. 1/4 S 17 BT.

II. Found:

A downed pine snag, 24 ins. diam., bears N.27°E., 7.26 ft. dist. with visible scribing.

A fir stump, 30 ins. diam. bears S.78°W., 58.08 ft. dist. no visible scribing or face.

III. Perpetuation: At a position determined from found original bearing trees, ; we set a Alum. pipe 2 1/2 ins. diam., 30 ins. long 24 ins. in the ground, with a 3 1/4 ins. diam. Alum. cap marked as shown below from which:

A fir, 9 ins. diam., bears S.52°E., 10.80 ft. dist. scribed 1/4 S16 BT.

A fir, 10 ins. diam., bears S.80°W., 21.00 ft. dist., scribed 1/4 S17 BT.

Painted faces and 6 in. wide red bands to all bearing trees and attached Land Survey Monument and Bearing Tree signs.

Set a steel fence post 4 ft. N. of monument.

Magnetic declination: 20° East assumed

Equipment used: Hand compass and loggers tape

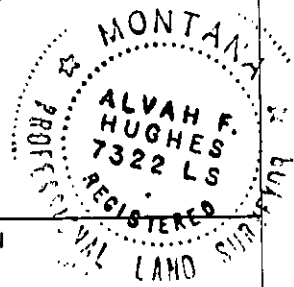
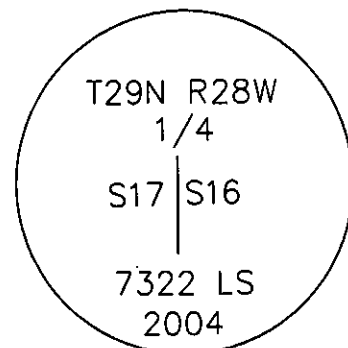

Kootenai Surveyors Inc., 314 California Av., Libby, MT. 59923 (406) 293-4354

KSI Project: East Richards - PCTC

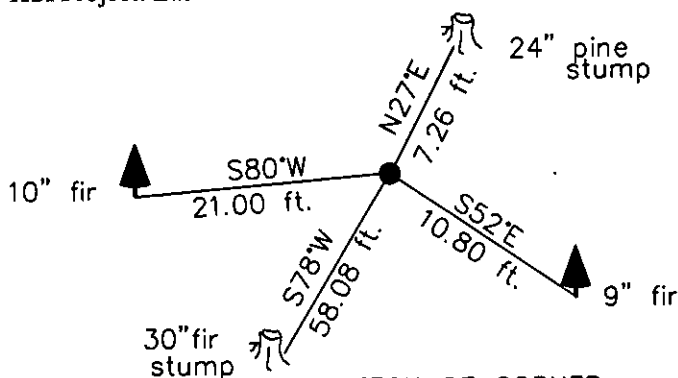

SKETCH OF CORNER

CERTIFICATION

I, Doug Schuhknecht
certify the information shown herein is true and correct.

[Signature]
Signature Ground Party Chief

I, Alvah F. Hughes
certify that this Corner Record correctly represents work performed by me or under my direction in compliance with the "Corner Recordation Act" (70-22-101, et seq., M.C.A.)

[Signature] 7322LS
Signature of Surveyor & Seal

Date: 12/1/2004 Reg. No. 7322-LS

Employer: Kootenai Surveyors Inc.

Office of Clerk and ' 181266 BOOK: CCR CC&R'S PAGE: 10717 Pages: 1
record" was filed for STATE OF MONTANA LINCOLN COUNTY
was noted on the c RECORDED: 12/14/2004 1:05 KOI: CC&R'S
book No. CORAL M. CUMMINGS CLERK AND RECORDER
FEE: \$0.00 BY: [Signature]
TO: FILED County Official

Sec. 16

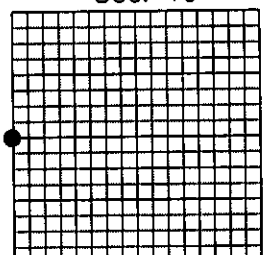

• corner this sheet

Cross Index No. L 9 T. 29N R. 28W P.M., MT

Adopted July 1, 1981, Montana Board of Professional Engineers & Land Surveyors