

# CERTIFIED CORNER RECORDATION

CORNER SW CORNER SEC. 25 T. 29N R. 27W P.M.M., LINCOLN COUNTY

FOUND: 3 1/4" BRASS CAP STAMPED AS SHOWN, FROM WHICH;  
 11" FIR BEARS N11°E 23.80' WITH OVERGROWN SCRIBE.  
 18" FIR BEARS N62°W 20.50' WITH OVERGROWN SCRIBE.

MAINTENANCE: REMOVED TREE LIMBS FROM CORNER AND PAINTED BT'S.  
 SET A 5 FOOT STEEL POST ON NORTH SIDE OF MONUMENT.

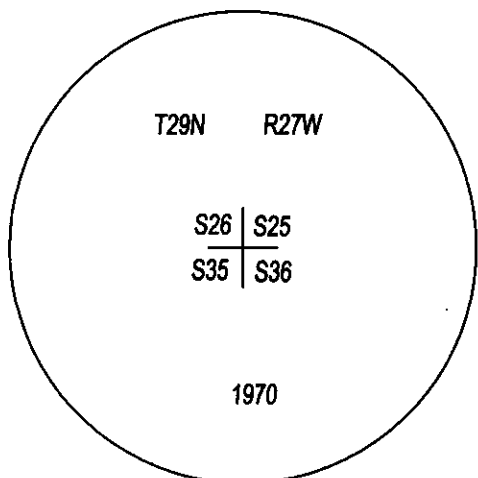
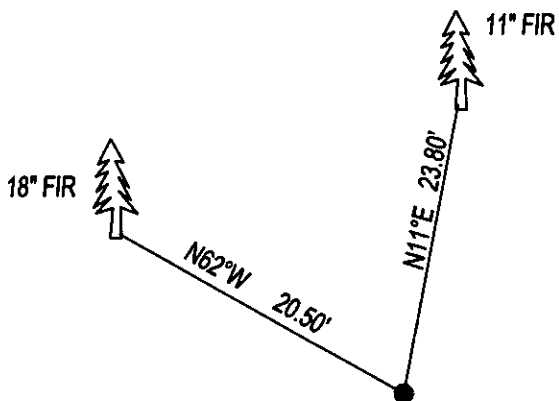

SKETCH OF CORNER

### CERTIFICATION

I, DAN CROFT  
 CERTIFY THE INFORMATION SHOWN HEREIN IS TRUE AND CORRECT.

SIGNATURE GROUND PARTY CHIEF

I, MARC J. CARSTENS  
 CERTIFY THAT THIS CORNER RECORD CORRECTLY REPRESENTS WORK  
 PERFORMED BY ME OR UNDER MY DIRECTION IN COMPLIANCE WITH THE  
 "CORNER RECORDATION ACT" (70-22-101, ET SEQ., M.C.A.)

*[Signature]*  
 SIGNATURE OF SURVEYOR & SEAL

02-08-13

DATE

CARSTENS SURVEYING

EMPLOYER

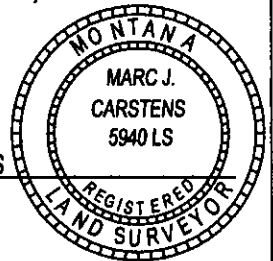

5940LS  
 REG. NO.

OFFICE OF CLERK AND RECORDER, COUNTY OF LINCOLN  
 THIS "CORNER RECORD" WAS FILED FOR R/ 243436 BOOK: CCR CC&R'S PAGE: 12010 Pages: 1  
 WAS NOTED O, STATE OF MONTANA LINCOLN COUNTY  
 AND IS ASSIGNED PAGE NO. \_\_\_\_\_ IN RECORDED: 02/12/2013 9:50 KOI: CC&R'S  
 TAMMY D. LAUER CLERK AND RECORDER  
 COUNTY OFFICIAL FEE: \$0.00 BY *[Signature]*  
 FOR: MARC J. CARSTENS  
 CROSS INDEX NO. V-21 T. 29N R. 27W P.M.M.  
 ADOPTED JULY 1, 1981, MONTANA BOARD OF PROFESSIONAL ENGINEERS & LAND SURVEYORS

SEC. 25

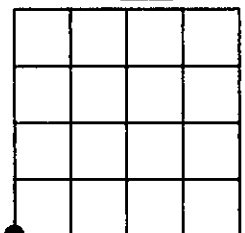

● CORNER THIS SHEET