

CERTIFIED CORNER RECORDATION

CORNER NW CORNER SEC. 25 T. 29N R. 27W P.M.M., LINCOLN COUNTY

FOUND: 3 1/4" BRASS CAP STAMPED AS SHOWN, IN A MOUND OF STONE, FROM WHICH;  
9" LARCH BEARS N72°E 27.70' WITH OVERGROWN SCRIBE.  
18" PINE BEARS S61°W 125.40' WITH SCRIBE.  
14" FIR BEARS N30°W 48.80' WITH OVERGROWN SCRIBE.

MAINTENANCE: SET A 5 FOOT STEEL POST 3 FEET SOUTH AND PAINTED BT'S RED.

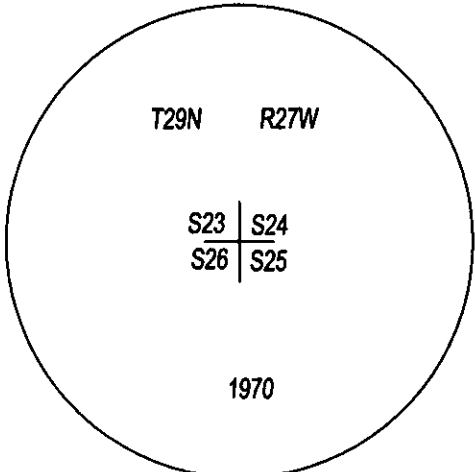
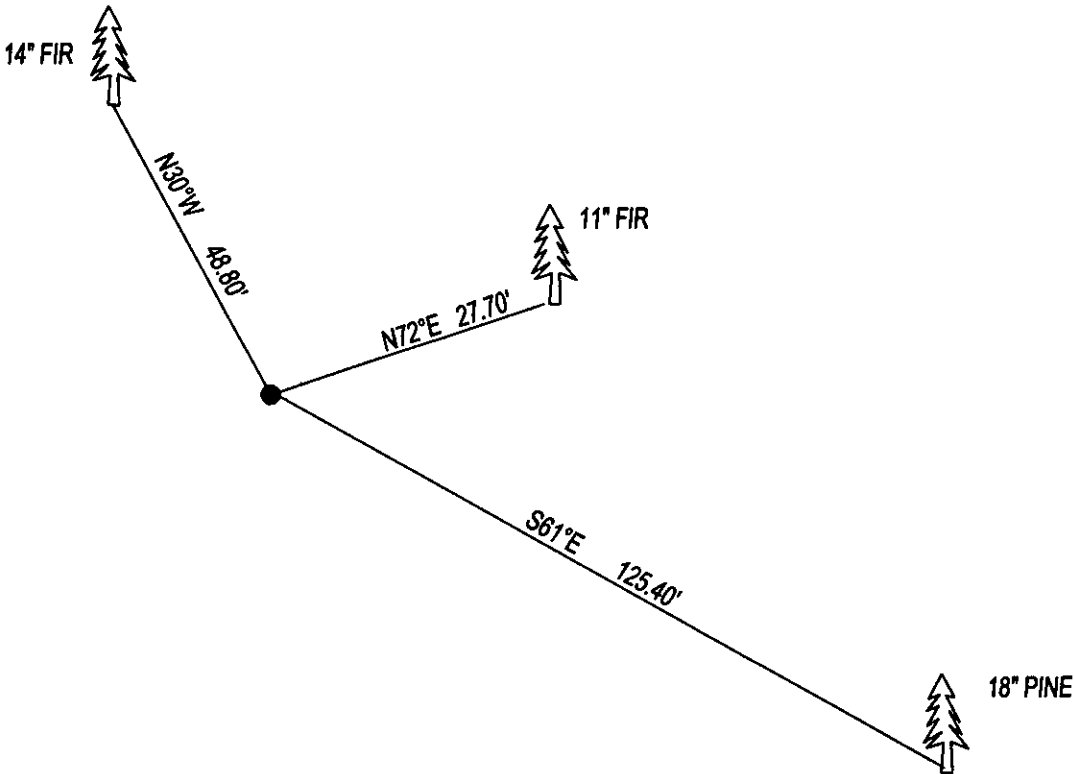

SKETCH OF CORNER

CERTIFICATION

I, DAN CROFT  
CERTIFY THE INFORMATION SHOWN HEREIN IS TRUE AND CORRECT.

SIGNATURE GROUND PARTY CHIEF

I, MARC J. CARSTENS  
CERTIFY THAT THIS CORNER RECORD CORRECTLY REPRESENTS WORK  
PERFORMED BY ME OR UNDER MY DIRECTION IN COMPLIANCE WITH THE  
"CORNER RECORDATION ACT" (70-22-101, ET SEQ., M.C.A.)

[Signature]  
SIGNATURE OF SURVEYOR & SEAL

02-08-13  
DATE  
CARSTENS SURVEYING  
EMPLOYER

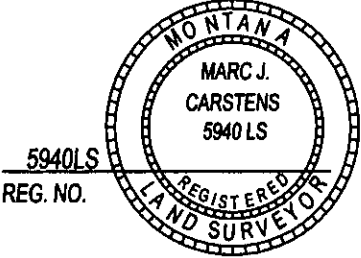

5940LS  
REG. NO.

OFFICE OF CLERK AND RECORDER, COUNTY OF LINCOLN  
THIS "CORNER RECORD" WAS FILED FOR RECO 243434 BOOK: CCR CC&R'S PAGE: 12008 Pages: 1  
WAS NOTED ON THE STATE OF MONTANA LINCOLN COUNTY  
AND IS ASSIGNED PAGE NO. \_\_\_\_\_, IN BOX RECORDED: 02/12/2013 9:40 KOI: CC&R'S  
TAMMY D. LAUER CLERK AND RECORDER  
FEE: \$0.00 BY: [Signature]  
FOR: MARC J. CARSTENS  
COUNTY OFFICIAL  
CROSS INDEX NO. R-21 T. 29N R. 27W P.M.M.  
ADOPTED JULY 1, 1981, MONTANA BOARD OF PROFESSIONAL ENGINEERS & LAND SURVEYORS

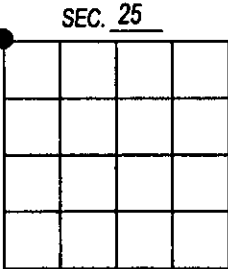

● CORNER THIS SHEET