

CERTIFIED CORNER RECORDATION

CORNER NE CORNER SEC. 24 T. 29N, R. 27W, P.M.M., LINCOLN COUNTY

FOUND: 3 1/4" ALUM CAP STAMPED AS SHOWN, FROM WHICH;
9" FIR BEARS S2°W 18.90' WITH SCRIBE.
22" LARCH SNAG BEARS S42°W 49.80' WITH SOME SCRIBE.
11" FIR BEARS N48°W 31.10' WITH SOME SCRIBE.

MAINTENANCE: REMOVED TREE LIMBS FROM CORNER AND PAINTED BT'S.

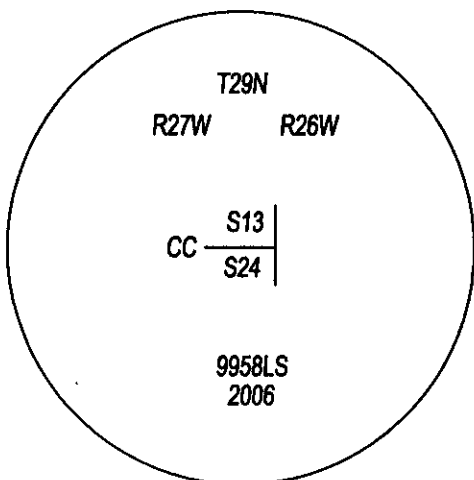
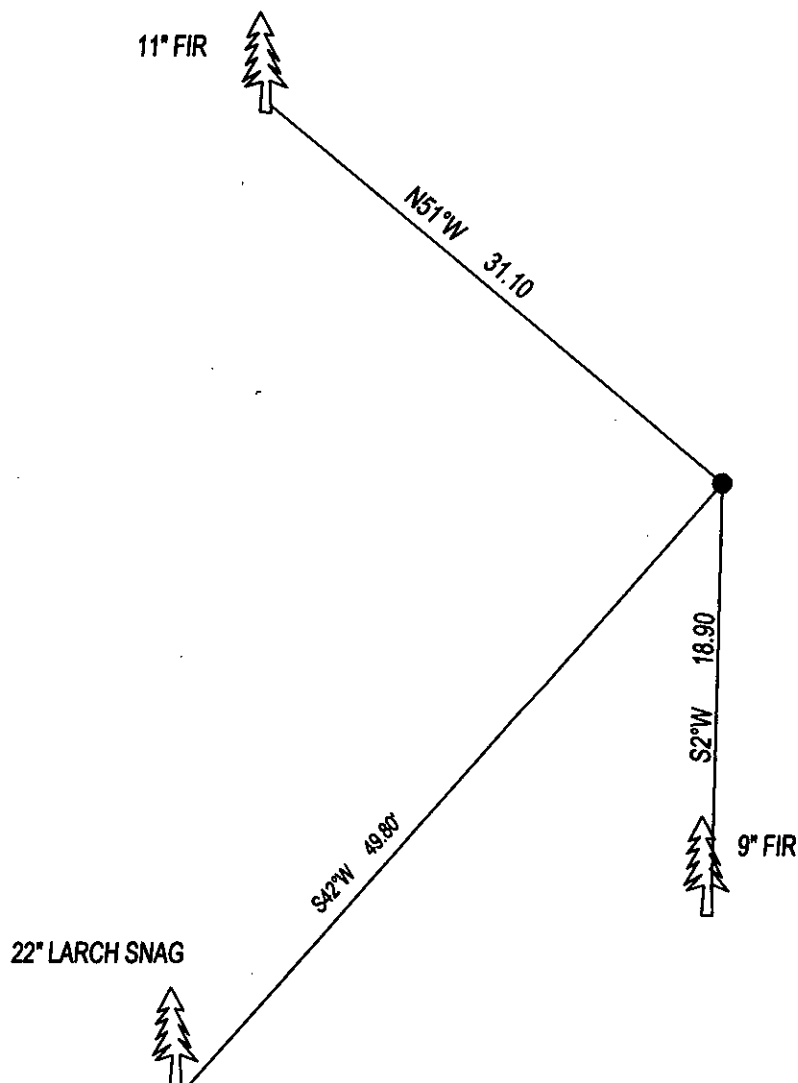

SKETCH OF CORNER

CERTIFICATION

I, DAN CROFT
CERTIFY THE INFORMATION SHOWN HEREIN IS TRUE AND CORRECT.

SIGNATURE GROUND PARTY CHIEF

I, MARC J. CARSTENS
CERTIFY THAT THIS CORNER RECORD CORRECTLY REPRESENTS WORK
PERFORMED BY ME OR UNDER MY DIRECTION IN COMPLIANCE WITH THE
"CORNER RECORDATION ACT" (70-22-101, ET SEQ., M.C.A.)



SIGNATURE OF SURVEYOR & SEAL

02-08-13

DATE

CARSTENS SURVEYING

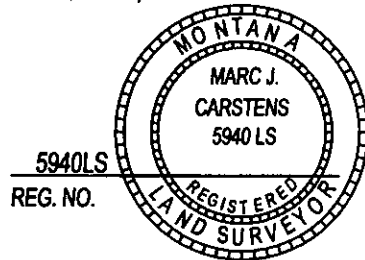
EMPLOYER



5940LS
REG. NO.

OFFICE OF CLERK AND RECORDER, COUNTY OF LINCOLN

THIS "CORNER RECORD" WAS FILED 243429 BOOK: CCR CC&R'S PAGE: 12003 Pages: 1

WAS STATE OF MONTANA LINCOLN COUNTY

AND IS ASSIGNED PAGE NO. RECORDED: 02/12/2013 9:15 KOI: CC&R'S

TAMMY D. LAUER CLERK AND RECORDER

FEE: \$0.00

COUNTY OFFICIAL FOR: MARC J. CARSTENS

CROSS INDEX NO. N-25 T. 29N, R. 27W, P.M.M.

ADOPTED JULY 1, 1981, MONTANA BOARD OF PROFESSIONAL ENGINEERS & LAND SURVEYORS

SEC. 24

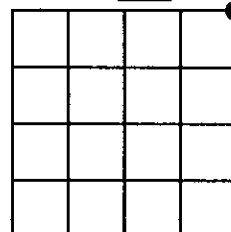

● CORNER THIS SHEET

