

CERTIFIED CORNER RECORDATION

CORNER CE 1/16 SEC. 24 T. 29N R. 27W P.M.M., LINCOLN COUNTY

RECORD : NONE

FOUND: NOTHING

SET: 5/8"x24" REBAR WITH YPC STAMPED AS SHOWN, FROM WHICH;  
13" FIR BEARS N02°E 8.90 SCRIBED RM .  
SET 5" STEEL POSTS 1.5 FEET NORTH AND 2 FEET WEST OF CORNER.

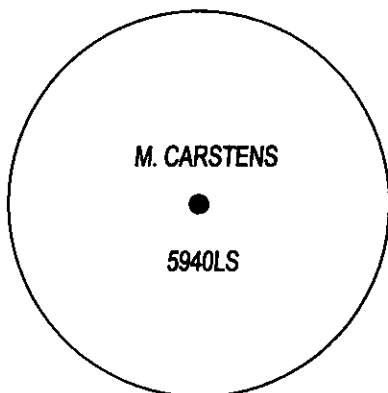
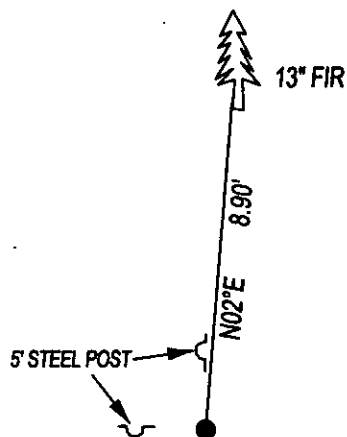

SKETCH OF CORNER

CERTIFICATION

I, DAN CROFT  
CERTIFY THE INFORMATION SHOWN HEREIN IS TRUE AND CORRECT.

SIGNATURE GROUND PARTY CHIEF

I, MARC J. CARSTENS  
CERTIFY THAT THIS CORNER RECORD CORRECTLY REPRESENTS WORK  
PERFORMED BY ME OR UNDER MY DIRECTION IN COMPLIANCE WITH THE  
"CORNER RECORDATION ACT" (70-22-101, ET SEQ., M.C.A.)

[Signature]  
SIGNATURE OF SURVEYOR & SEAL

02-08-13

DATE

CARSTENS SURVEYING

EMPLOYER

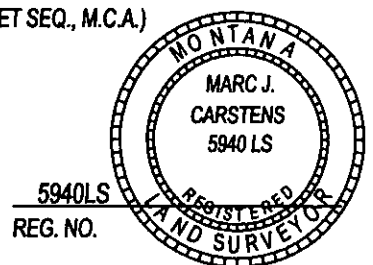

5940LS  
REG. NO.

OFFICE OF CLERK AND RECORDER, COUNTY OF LINCOLN  
THIS "CORNER RECO" 243428 BOOK: CCR CC&R'S PAGE: 12002 Pages: 1  
STATE OF MONTANA LINCOLN COUNTY  
AND IS ASSIGNED PA RECORDED: 02/12/2013 9:10 KOI: CC&R'S  
TAMMY D. LAUER CLERK AND RECORDER  
FEE: \$0.00 BY: [Signature]  
COUNTY OFFICIAL FOR: MARC J. CARSTENS  
CROSS INDEX NO. P-24 T. 29N R. 27W P.M.M.  
ADOPTED JULY 1, 1981, MONTANA BOARD OF PROFESSIONAL ENGINEERS & LAND SURVEYORS

SEC. 24

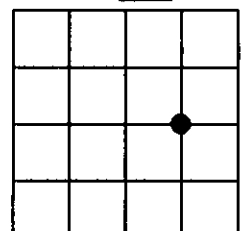

● CORNER THIS SHEET

