

INSTRUCTIONS

1. Original and/or subsequent record used to evaluate the corner position.
2. Description of evidence found, note discrepancies in the record, state method of establishing lost or obliterated corners.
3. Description of monument and accessories set to perpetuate the corner position.
4. Sketch of corner, show all pertinent data which can best be shown in a sketch example, corner marking, topography ties, position of accessories, etc.
5. Certification must be signed and sealed by Land Surveyor registered in the State of Montana.
6. Fill in Cross Index & Section Diagram at bottom of sheet.

CERTIFIED CORNER RECORDATION

Corner S1/4 SEC. 13 T. 29N R. 27W P.M.M. Lincoln County

ORIGINAL:

GLO - Paul S.A. Bickel - 1901

Set a limestone, 21x11x3 inches, 16 inches in the ground, for the 1/4 Section Corner marked 1/4 on north face; from which:

A Fir, 14 inches diameter, bears S53°15'E, 65 links (42.9 feet) distant, marked "1/4 S24 BT"

A Fir, 12 inches diameter, bears N55°W, 45 links (29.7 feet) distant, marked "1/4 S13 BT"

FOUND:

Found two original bearing trees:

A 25" Fir in good condition with healed blaze and snow blaze.

A 22" Fir snag, 6 feet tall, with visible scribing.

ESTABLISH:

Establish position for 1/4 corner from bearing-bearing intersect from found original bearing tree evidence. Set a 3/4" aluminum cap on 2 1/2" standard aluminum monument, marked as shown below. Corner monument is 0.5' above ground with small rock cairn around base of monument; from which establish one new accessory for this corner:

A 14" Fir bears S15 1/4°E, 22.1 feet distant, blaze and scribe "1/4 S24 BT"

Bearing trees were painted red and bearing tree tags were attached.

Set a steel post 3.0' east of corner monument.

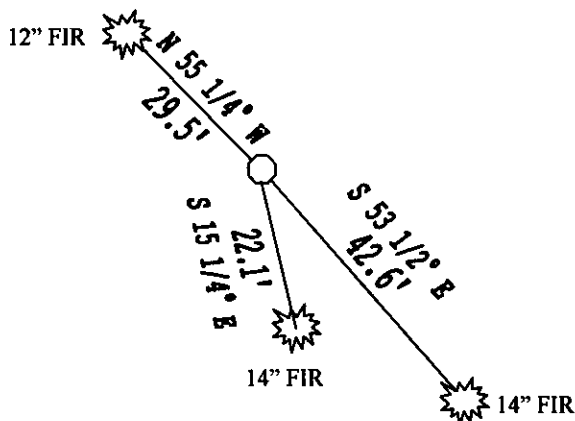
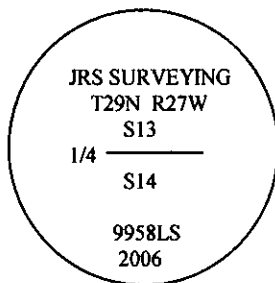

SKETCH OF CORNER

CERTIFICATION

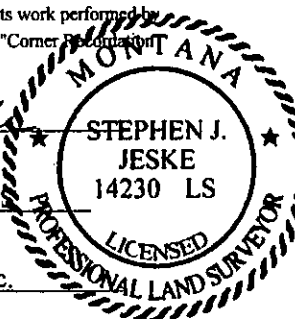
I, Stephen Jeske
Certify the information shown herein is true and correct.
Signature Ground Party ChiefI, Stephen Jeske
certify that this Corner Record correctly represents work performed by me or under my direction in compliance with the "Corner Recordation Act" (70-22-101, et seq., M.C.A.)
Signature of Surveyor & SealDate: 05-27-08 Reg. No. 14230LSEmployer: J.R.S. Surveying, Inc.

Office of Clerk and Recorder, County of _____ This "corner

record" was filed for record on 211727 BOOK: CCR CC&R'S PAGE: 11207 Pages: 1was noted on the cross-index plat STATE OF MONTANA LINCOLN COUNTY

book no. _____ TAMMY D. LAUER CLERK AND RECORDER

FEE: \$0.00

BY:

TO: J.R.S. SURVEYING P.O. BOX 1050, LIBBY, MONTANA 59923

Cross Index No. N23 T. 29N R. 27W PMM

Adopted July 1, 1981, Montana Board of Professional Engineers & Land Surveyors

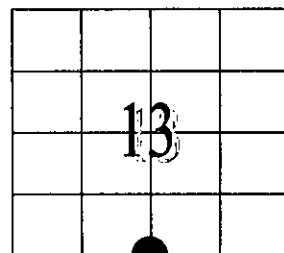

• - Corner this sheet