

INSTRUCTIONS

1. Original and/or subsequent record used to evaluate the corner position.
2. Description of evidence found, note discrepancies in the record, state method of establishing lost or obliterated corners.
3. Description of monument and accessories set to perpetuate the corner position.
4. Sketch of corner, show all pertinent data which can best be shown in a sketch example, corner marking, topography ties, position of accessories, etc.
5. Certification must be signed and sealed by Land Surveyor registered in the State of Montana.
6. Fill in Cross Index & Section Diagram at bottom of sheet.

CERTIFIED CORNER RECORDATION

Corner C1/4 SEC. 14 T. 29N R. 27W P.M.M. Lincoln County

The new corner monument was established as a result of a subdivisional survey of the Section. Said subdivisional survey was made in accordance with methods and procedures contained in the Manual of Surveying Instructions (1973); U.S. Bureau of Land Management.

FOUND:

No evidence of corner found.

ESTABLISH:

Set a 5/8" x 30" rebar with 3/4" aluminum cap, marked as shown below; from which:

A 10" Fir bears S37°37'38"W, 13.21 feet distant, blaze and scribe "C1/4 S14 BT"

A 13" Larch bears N56°20'29"W, 42.14 feet distant, blaze and scribe "C1/4 S14 BT"

Bearing trees were painted red and bearing tree tags were attached.

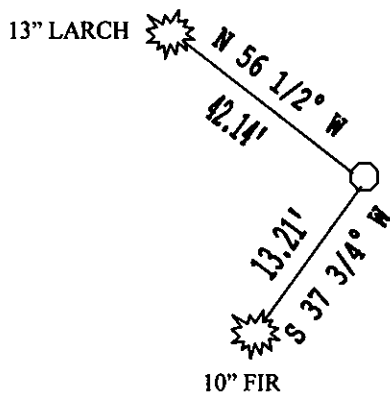
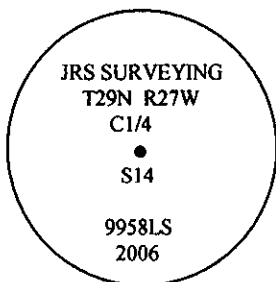

SKETCH OF CORNER

CERTIFICATION

I, Stephen Jeske
Certify the information shown herein is true and correct.

Stephen Jeske
Signature Ground Party Chief

I, Stephen Jeske
certify that this Corner Record correctly represents work performed by me or under my direction in compliance with the "Corner Recordation Act" (70-22-101, et seq., M.C.A.)

Stephen Jeske
Signature of Surveyor & Seal

Date: 05-27-08 Reg. No. 14230LS

Employer: J.R.S. Surveying, Inc.

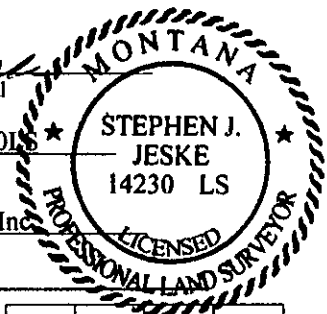

Office of Clerk and Recorder, County of _____ This "corner

record" was filed for record on _____ 211726 BOOK: CCR CC&R'S PAGE: 11206 Pages: 1

was noted on the cross-index plat and STATE OF MONTANA LINCOLN COUNTY

book no. _____ RECORDED: 05/29/2008 10:29 KOI: CC&R'S

TAMMY D. LAUER CLERK AND RECORDER

FEE: \$0.00

BY: *Julie Blomdahl, Deputy*

TO: J.R.S. SURVEYING P.O. BOX 1050, LIBBY, MONTANA 59923

Cross Index No. L19 T. 29N R. 27W PMM

	14		

• - Corner this sheet