

CERTIFIED CORNER RECORDATION

Corner SW 1/16 S4 T 29 N. R. 27 W. P.M.M. Lincoln County

I. Record: None

II. Found: No monuments found during area search.

III. Perpetuation: At the corner point, determined by survey, set a 5/8 ins. diam. steel rebar 24 ins. long, 22 ins. in the ground, with a 1 1/2 ins. diam. Aluminum cap marked as shown below from which:

A pine, 6 ins. diam., bears S. 39° E., 29.92 ft. dist., scribed SW 1/16 S4 BT.

A pine, 6 ins. diam., bears S. 70° W., 13.35 ft. dist., scribed SW 1/16 S4 BT.

Pointed faces and 6 in. wide red bands to all bearing trees and attached Land Survey Monument and Bearing Tree signs.

Set a steel post on line 3 ft. East of set monument.

Magnetic declination: 18° East

Equipment used: Hand compass and loggers tape

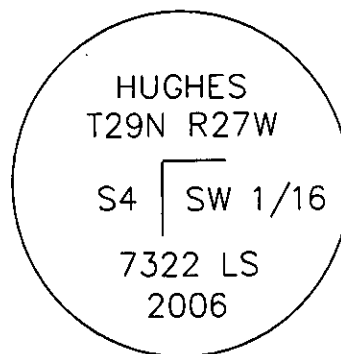

Kootenai Surveyors Inc., 314 California Av., Libby, MT. 59923 (406) 293-4354

Cross Wolf - PCTC

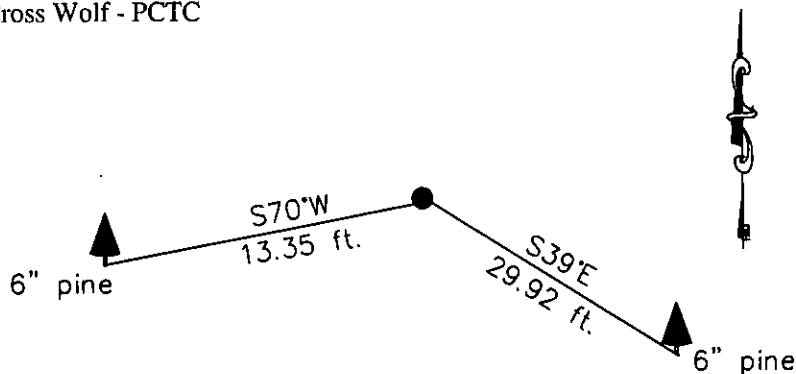

SKETCH OF CORNER

CERTIFICATION

I, Kelly Rooney
certify the information shown herein is true and correct.

Kelly Rooney
Signature Ground Party Chief

I, Alvah F. Hughes
certify that this Corner Record correctly represents work performed by me or under my direction in compliance with the "Corner Recordation Act" (70-22-101, et seq., M.C.A.)

Alvah F. Hughes
Signature of Surveyor & Sec. 4

Date: 11/30/2006 Reg. No. 7322-LS 7322/LS

Employer: Kootenai Surveyors Inc.

Sec. 4

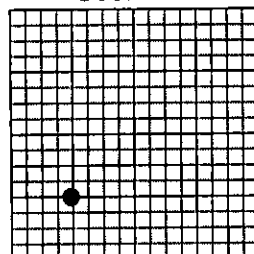

• corner this sheet

Office of Clerk and Recorder, County of Lincoln This "corner

record" was filed for record on 200847 BOOK: CCR CC&R'S PAGE: 11048 Pages: 1

was noted on the cross-index STATE OF MONTANA LINCOLN COUNTY

book No. TAMMY D. LAUER CLERK AND RECORDER

FEE: \$0.00

BY: Deanne Deanne

TO: FILED

Cross Index No. D 10 T. 29N R. 27W P.M., MT

Adopted July 1, 1981, Montana Board of Professional Engineers & Land Surveyors