

CERTIFIED CORNER RECORDATION

Corner N 1/4 S4 T 29 N. R. 27 W. P.M.M. Lincoln County

I. Record: 1893 original GLO survey by J. Keerl and A. Jaqueth: Set a post 3 ft. long, 3 ins. square, 24 ins. in the ground, marked 1/4 on the N. face, from which:

A fir, 6 ins. diam., bears S. 25° E., 7 lks. dist. (4.62 ft.) mkd. 1/4 S4 BT.

A fir, 6 ins. diam., bears N. 52° W., 16 lks. dist. (10.56 ft.) mkd. 1/4 S33 BT.

II. Found: No monuments or accessories were found during a field search of area:

III. Perpetuation: At the corner point, determined by survey, set a Aluminum pipe 2 1/2 ins. diam., 30 ins. long, 25 ins. in the ground, with a 3 1/4 ins. diam. Aluminum cap marked as shown below from which:

A fir, 8 ins. diam., bears N. 75° E., 14.59 ft. dist., scribed 1/4 S33 BT.

A fir, 9 ins. diam., bears S. 40° E., 14.50 ft. dist., scribed 1/4 S4 BT.

Painted faces and 6 in. wide red bands to all bearing trees and attached Land Survey Monument and Bearing Tree signs.

Raise a collar of stone 1 1/2 ft. diam., 1 ft. high around set monument.

Magnetic declination: 18° East

Equipment used: Hand compass and loggers tape

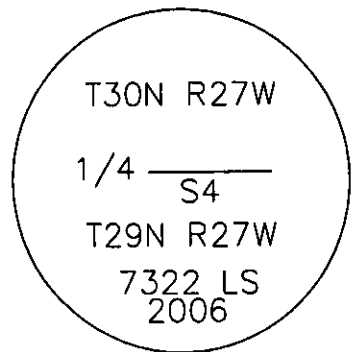

Kootenai Surveyors Inc., 314 California Av., Libby, MT. 59923 (406) 293-4354

Cross Wolf- PCTC

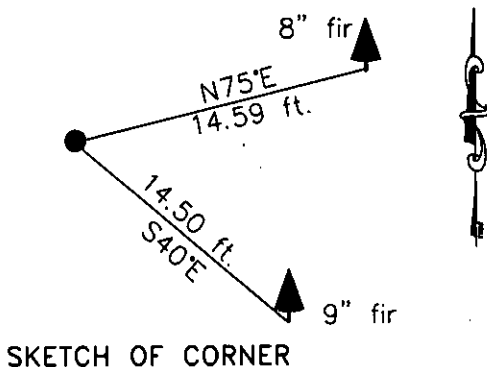

SKETCH OF CORNER

CERTIFICATION

I, Kelly Rooney
certify the information shown herein is true and correct.

Kelly Rooney
Signature Group Party Chief

I, Alvah F. Hughes
certify that this Corner Record correctly represents work performed by me or under my direction in compliance with the "Corner Recordation Act" (70-22-101, et seq., M.C.A.)

Alvah F. Hughes
Signature of Surveyor & Seal

Date: 11/9/2006 Reg. No. 7322-LS

Employer: Kootenai Surveyors Inc.

Office of Clerk and Recorder, County of Lincoln. This "corner

record" was filed for record on

200843 BOOK: CCR CC&R'S PAGE: 11044 Pages: 1

was noted on the cross- STATE OF MONTANA LINCOLN COUNTY

book No. RECORDED: 02/07/2007 9:02 KOI: CC&R'S

TAMMY D. LAUER CLERK AND RECORDER

FEE: \$0.00

TO: FILED

BY: Francis Lauer
Deputy

Cross Index No. A 11 T. 29N R. 27W P.M., MT

Adopted July 1, 1981, Montana Board of Professional Engineers & Land Surveyors

\\Manon\manon-shared\Corner Rec\Cross Wolf PCTC.dwg, 1/2/2007 12:39:15 PM, Konka

Sec. 4

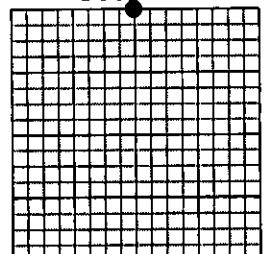

• corner this sheet