

CERTIFIED CORNER RECORDATION

Corner W 1/4 S4 T 29 N. R. 27 W. P.M.M. Lincoln County

I. Record: 1902 original GLO survey by Paul S. Bickel: Set a trachite stone, 18x9x6 ins. 12 ins. the ground, marked 1/4 on the W face from which:

- A fir, 28 ins. diam., bears East, 82 lks. dist., (54.12 ft.), mkd. 1/4 S4 BT.
- A pine, 22 ins. diam., bears N. 36°W., 41 lks. dist., (27.06 ft.), mkd. 1/4 S5 BT.

1966 BLM Remonumentation by R. Leedy : Set an iron post, 30 ins. long, 2 1/2 ins. diam., 24 ins. in the ground, with brass cap from which:

- A fir, 39 ins. diam., bears S. 87° E., 82 lks. dist. with visible scribes.
- A pine, 26 ins. diam., bears N. 35° W., 41 lks. dist. with visible scribes.

II. Found: A 3 1/4 ins. diam. BLM brass cap on a 2 1/2 ins. diam. iron pipe loosely set from which:

- A fir, 39 ins. diam., bears S. 87° E., 54.12 ft. dist. with healed face.
- A pine snag, (fallen over) 26 ins. diam., bears N. 35° W., 27.06 ft. dist., with visible scribes. Note: dist. taken from root crown.

III. Perpetuation: Establish one bearing tree described below:

A fir, 15 ins. diam., bears N. 53° W., 14.60 ft. dist., scribed 1/4 S5 BT.

Raise a collar of stone 3 ft. diam., 1.5 ft. high around brass cap.

Painted faces and 6 in. wide red bands to all bearing trees and attached Land Survey Monument and Bearing Tree signs.

Magnetic declination: 18° East

Equipment used: Hand compass and loggers tape

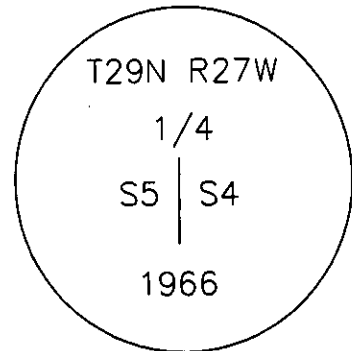

Kootenai Surveyors Inc., 314 California Av., Libby, MT. 59923 (406) 293-4354

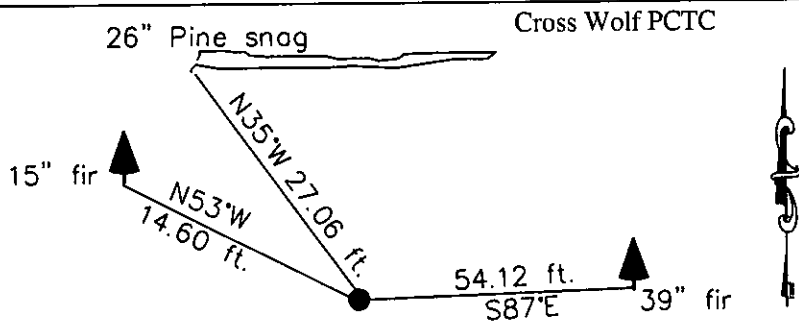

CERTIFICATION

I, Kelly Rooney
certify the information shown herein is true and correct.
Kelly Rooney
Signature Group Party Chief

I, Alvah F. Hughes
certify that this Corner Record correctly represents work performed by me or under my direction in compliance with the "Corner Recordation Act" (70-22-101, et seq., M.C.A.)
Alvah F. Hughes
Signature of Surveyor & Seal: **ALVAH F. HUGHES**
7322-LSA
Date: 10/31/2006 Reg. No. 7322-LSA
Employer: Kootenai Surveyors Inc.

Office of Clerk and Recorder, County of Lincoln This "corner

Sec. 4

record" was filed for record on 200842 BOOK: CCR CC&R'S PAGE: 11043 Pages: 1
was noted on the cross-in STATE OF MONTANA LINCOLN COUNTY
book No. _____ RECORDED: 02/07/2007 9:01 KOI: CC&R'S

TAMMY D. LAUER CLERK AND RECORDER

FEE: \$0.00
TO: FILED

BY: *Tammy D. Lauer*
Deputy

Cross Index No. C 09 T. 29N R. 27W P.M., MT

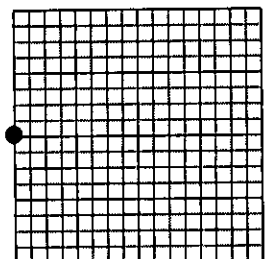

• corner this sheet

Adopted July 1, 1981, Montana Board of Professional Engineers & Land Surveyors