

CERTIFIED CORNER RECORDATION

Corner N 1/16 S11 T 29 N. R. 27 W. P.M.M. Lincoln County

I. Record: None

II. Found: No monuments found during area search.

III. Perpetuation: At the corner point, determined by survey, set a 5/8 ins. diam. steel rebar 24 ins. long 22 ins. in the ground, with a 1 1/2 ins. diam. Aluminum cap marked as shown below from which:

- A pine, 5 ins. diam., bears S. 23° W., 7.10 ft. dist., scribed N 1/16 S11 BT.
- A pine, 10 ins. diam., bears N. 8° E., 129.90 ft. dist., scribed N 1/16 S12 BT.

Painted faces and 6 in. wide red bands to all bearing trees and attached Land Survey Monument and Bearing Tree signs.

Magnetic declination: 18° East

Equipment used: Hand compass and loggers tape

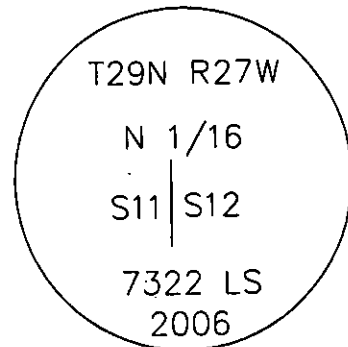

Kootenai Surveyors Inc., 314 California Av., Libby, MT. 59923 (406) 293-4354

HORSEHILL - PCTC

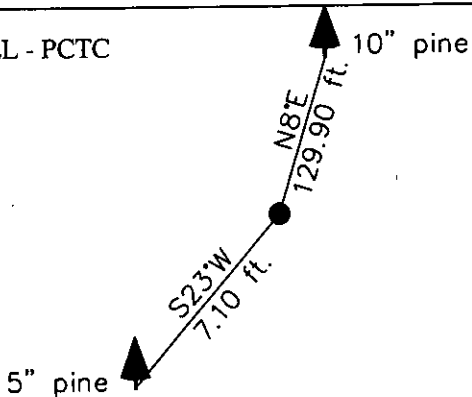

SKETCH OF CORNER

CERTIFICATION

I, Kelly Rooney
certify the information shown herein is true and correct.
Kelly Rooney
Signature Ground Party Chief

I, Alvah F. Hughes
certify that this Corner Record correctly represents work performed by me or under my direction in compliance with the "Corner Recordation Act" (70-22-101, et seq., M.C.A.)
Alvah F. Hughes
Signature of Surveyor & Seal

Date: 12/27/2006 Reg. No. 7322 LS 2006
Employer: Kootenai Surveyors, Inc.

Office of Clerk and Recorder, County of Lincoln This "corner

record" was filed for record c 200836 BOOK: CCR CC&R'S PAGE: 11037 Pages: 1
was noted on the cross-index STATE OF MONTANA LINCOLN COUNTY
book No. RECORDED: 02/06/2007 3:35 KOI: CC&R'S
TAMMY D. LAUER CLERK AND RECORDER
FEE: \$0.00 BY: *Tammy D. Lauer*
TO: FILED

Cross Index No. F 21 T. 29N R. 27W P.M., MT

Adopted July 1, 1981, Montana Board of Professional Engineers & Land Surveyors

Sec. 11

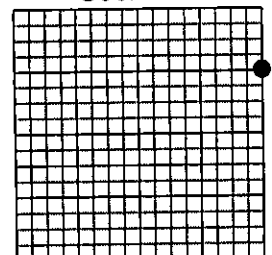

• corner this sheet