

CERTIFIED CORNER RECORDATION

Corner NW COR. S7 T. 29 N. R. 27 W. P.M.M. Lincoln County

I. Record: 1893 original GLO survey by J. Keerl and A. Jaqueth: Set a trachite stone 18x7x4 ins. 12 ins. in the ground, marked with 5 notches on the S. and 1 notch on the N. edges, from which:

A fir, 15 ins. diam., bears N. 4° E., 77 lks. dist. (50.82 ft.) mkd. T29N R27W S6 BT.
A alder, 5 ins. diam., bears S. 15°30' E., 58 lks. dist. (38.28 ft.) mkd. T29N R27W S7 BT.
A spruce, 6 ins. diam., bears S. 56°30' W., 30 lks. dist. (19.80 ft.) mkd. T29N R27W S12 BT.
A alder, 5 ins. diam., bears N. 88° W., 51 lks. dist. (33.66 ft.) mkd. T29N R27W S1 BT.

II. Found: A trachite stone 18x6x5 ins. 5 ins. above ground firmly set, with 5 notches on the South and 1 notch on North edges, from which:

A spruce, 24 ins. diam., bears S. 56° W., 19.80 ft. dist. with healed face. (Note: this bearing tree was effaced during later GLO surveys).

III. Perpetuation: At the corner point determined from found original stone monument, set a 2 1/2 ins. diam. Aluminum pipe 30 ins. long 26 ins. in the ground, with a 3 1/4 ins. diam. Aluminum cap marked as shown below from which:

A fir, 13 ins. diam., bears N. 46° E., 39.50 ft. dist., mkd. T29N R27W S6 BT.
A spruce, 22 ins. diam., bears S. 52° E., 48.95 ft. dist., mkd. T29N R27W S7 BT.

Painted faces and 6 in. wide red bands to all bearing trees and attached Land Survey Monument and Bearing Tree signs.

Set a steel post on line 3 ft. East of found monument.

Raise a mound of stone around found monument.

Magnetic declination: 18° East

Equipment used: Hand compass and loggers tape

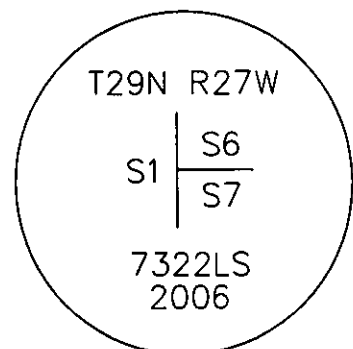

Kootenai Surveyors Inc., 314 California Av., Libby, MT. 59923 (406) 293-4354

Redeemed Big 8- PCTC

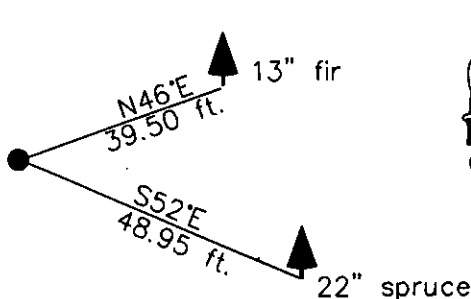

SKETCH OF CORNER

CERTIFICATION

I, Levi Powell
certify the information shown herein is true and correct.

Levi Powell
Signature Ground Party Chief

I, Alvah F. Hughes
certify that this Corner Record correctly represents work performed by me or under my direction in compliance with the "Corner Recordation Act" (70-22-101, et seq., M.C.A.).

Alvah F. Hughes
Signature of Surveyor & Seal: 7322LS

Date: 12/20/2006 Reg. No. 7322LS

Employer: Kootenai Surveyors, Inc.

Office of Clerk and Recorder, County of Lincoln This "corner

record" was filed for record

200815 BOOK: CCR CC&R'S PAGE: 11020 Pages: 1

was noted on the cross-in-

STATE OF MONTANA LINCOLN COUNTY

book No. _____

RECORDED: 02/06/2007 1:26 KOI: CC&R'S

TAMMY D. LAUER CLERK AND RECORDER

FEE: \$0.00

BY: *Alvah F. Hughes*

TO: FILED

Cross Index No. E 01 T. 29N R. 27W P.M., MT

Adopted July 1, 1981, Montana Board of Professional Engineers & Land Surveyors

Sec. 7

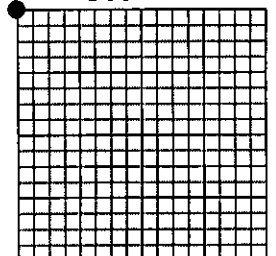

• corner this sheet