

CERTIFIED CORNER RECORDATION

Corner SE Cor. S7 T. 29 N. R. 27 W. P.M.M. LINCOLN County

- I. Record: 1902 original GLO survey by P. Bickel, set a trachite stone 20x9x6 ins., 15 ins. in the ground, marked with 4 notches on the S. and 5 notches on E. edges from which:
- A pine, 8 ins. diam., bears N. 43°15' E. 23 lks. dist. (15.18 ft.), mkd. T29N R27W S8 BT.
 - A pine, 9 ins. diam., bears S. 57°45' E. 50 lks. dist. (33.00 ft.), mkd. T29N R27W S17 BT.
 - A pine, 10 ins. diam., bears S. 28°33' W. 22 lks. dist. (14.52 ft.), mkd. T29N R27W S18 BT.
 - A pine, 11 ins. diam., bears N. 29°15' W. 49 lks. dist. (32.34 ft.), mkd. T29N R27W S7 BT.
- 1965 BLM Remoumentation by Lindenberg: Set an iron post, 30 ins. long, 2 1/2 ins. diam., 26 ins. in the ground, with brass cap mkd. as shown below from which:
- A fir, 11 ins. diam., bears N. 42°45' E., 37 lks. dist., (24.42 ft.) mkd. T29N R27W S8 BT.
 - A fir, 10 ins. diam., bears S. 52°30' E., 33 lks. dist., (21.78 ft.) mkd. T29N R27W S17 BT.
 - A fir, 12 ins. diam., bears S. 75°30' W., 82 lks. dist., (54.12 ft.) mkd. T29N R27W S18 BT.
 - A pine, 6 ins. diam., bears N. 14° W., 29 lks. dist., (19.14 ft.) mkd. T29N R27W S7 BT.
- II. Found: A 3 1/4 ins. diam. BLM brass cap on a 2 1/2 in. diam. iron pipe lying on the surface, disturbed from logging operations in the area, from which:
- A fir, 17 ins. diam., bears N. 42° E., 24.42 ft. dist., with overgrown face.
 - A fir, 14 ins. diam., bears S. 52° E., 21.78 ft. dist., with overgrown face.
 - A fir, 18 ins. diam., bears S. 75° W., 54.12 ft. dist., with overgrown face.
- III. Perpetuation: At the corner point, determined from existing bearing trees, set a 2 1/2 ins. diam. Aluminum pipe 30 ins. long 25 ins. in the ground with a 3 1/4 ins. diam. Aluminum cap, marked as shown below from which :
- A larch, 10 ins. diam., bears N. 28° W., 39.45 ft. dist., mkd. T29N R27W S7 BT.
- Painted faces and 6 in. wide red bands to all bearing trees and attached Bearing tree and Land Survey Monument signs.
- Magnetic declination: 18° East
- Equipment used: Hand compass and loggers tape

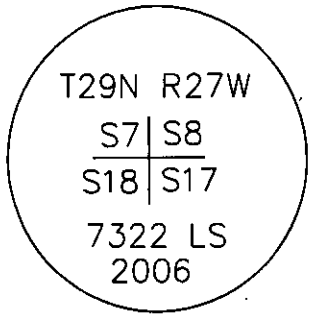

Kootenai Surveyors Inc., 314 California Av., Libby, MT. 59923 (406) 293-4354

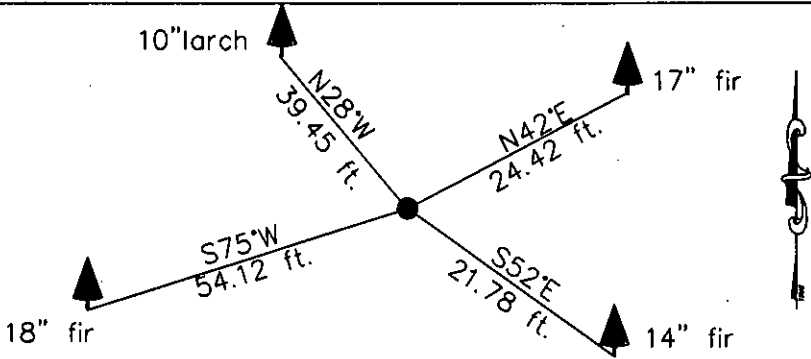

CERTIFICATION

I, Levi Powell
 certify the information shown herein is true and correct.
Levi Powell
 Signature Ground Party Chief

I, Alvah F. Hughes
 certify that this Corner Record correctly represents work performed by me or under my direction in compliance with the "Corner Recordation Act" (70-72-101, et seq., M.C.A.)
Alvah F. Hughes
 Signature of Surveyor & Registrar
 7322-LS
 REGISTERED

Date: 12/20/2006 Reg. No. 7322-LS
 Employer: Kootenai Surveyors Inc.

Redeemed Big 8- PCTC SKETCH OF CORNER

Office of Clerk and Recorder, County of Lincoln This "corner

record" was filed for record on 200814 BOOK: CCR CC&R'S PAGE: 11019 Pages: 1
 was noted on the cross-index of STATE OF MONTANA LINCOLN COUNTY
 book No. RECORDED: 02/06/2007 1:25 KOI: CC&R'S
TAMMY D. LAUER CLERK AND RECORDER
 FEE: \$0.00 BY: *Tammy D. Lauer*
 TO: FILED

Cross Index No. J 05 T. 29N R. 27W P.M., MT

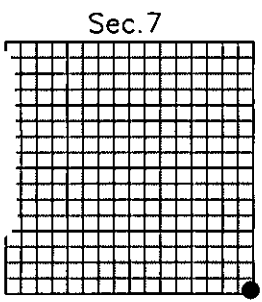

Adopted July 1, 1981, Montana Board of Professional Engineers & Land Surveyors

• corner this sheet

\\Manon\manon-shared\Corner Rec\Redeemed Big 8 PCTC.dwg, 12/29/2006 3:48:18 PM, Konka