

CERTIFIED CORNER RECORDATION

Corner W 1/16 S17 T. 29 N. R. 27 W. P.M.M. Lincoln County

I. Record: None

II. Found: No monument or accessories found during area search.

III. Perpetuation: At the corner point, determined by survey, set a 5/8 ins. diam. steel rebar 24 ins. long 22 ins. in the ground, with a 3 1/4 ins. diam. Aluminum cap marked as shown below from which:

A pine, 6 ins. diam., bears N. 21° E., 23.15 ft. dist., scribed W 1/16 S8 BT.
A pine, 8 ins. diam., bears S. 37° W., 14.15 ft. dist., scribed W 1/16 S17 BT.

Painted faces and 6 in. wide red bands to all bearing trees and attached Land Survey Monument and Bearing Tree signs.

Magnetic declination: 18° East

Equipment used: Hand compass and loggers tape

T29N R27W
W 1/16
S8
S17
7322 LS
2007

Kootenai Surveyors Inc., 314 California Av., Libby, MT. 59923 (406) 293-4354

Redeemed Big 8- PCTC

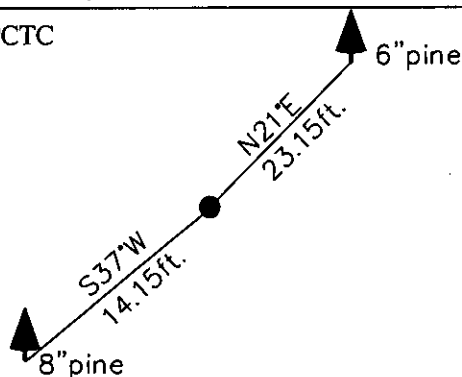

SKETCH OF CORNER

CERTIFICATION

Levi Powell
I certify the information shown herein is true and correct.

Levi Powell
Signature Ground Party Chief

Alvah F. Hughes
I certify that this Corner Record correctly represents work performed by me or under my direction in compliance with the "Corner Recordation Act" (70-22-101, et. seq.)

Alvah F. Hughes
Signature of Surveyor & Seal

Date: 1/11/2007 Reg. No. 7322-LS

Employer: Kootenai Surveyors Inc.

Office of Clerk and Recorder, County of Lincoln This "corner

record" was filed for record 200809 BOOK: CCR CC&R'S PAGE: 11014 Pages: 1

was noted on the cross- STATE OF MONTANA LINCOLN COUNTY

book No. TAMMY D. LAUER CLERK AND RECORDER

FEE: \$0.00

BY: *Tammy D. Lauer*

TO: FILED

Cross Index No. J 18 6 T. 29N R. 27W P.M., MT

Adopted July 1, 1981, Montana Board of Professional Engineers & Land Surveyors

\\Manon\manon-shared\Corner Rec\Redeemed Big 8 PCTC.dwg, 1/16/2007 9:11:52 AM, Konica

Sec.17

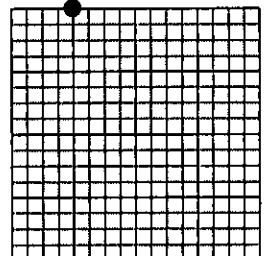

• corner this sheet