

CERTIFIED CORNER RECORDATION

Corner NW 1/16 S17 T 29 N. R. 27 W. P.M.M. Lincoln County

I. Record: None

II. Found: No monument or accessories found during area search.

III. Perpetuation: At the corner point, determined by survey, set a 5/8 ins. diam. steel rebar 24 ins. long 22 ins. in the ground, with a 3 1/4 ins. diam. Aluminum cap marked as shown below from which:

A pine, 10 ins. diam., bears N. 73° E., 73.30 ft. dist., scribed NW 1/16 S17 BT.
A pine, 8 ins. diam., bears N. 7° E., 61.30 ft. dist., scribed NW 1/16 S17 BT.

Painted faces and 6 in. wide red bands to all bearing trees and attached Land Survey Monument and Bearing Tree signs.

Magnetic declination: 18° East

Equipment used: Hand compass and loggers tape

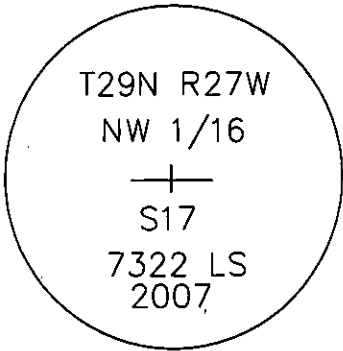

Kootenai Surveyors Inc., 314 California Av., Libby, MT. 59923 (406) 293-4354

Redeemed Big 8- PCTC

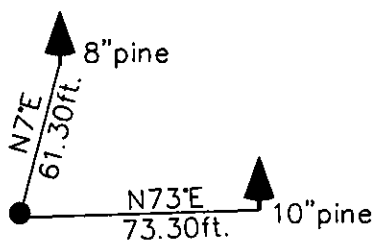

SKETCH OF CORNER

CERTIFICATION

I, Levi Powell, certify the information shown herein is true and correct.

Signature of Ground Party Chief

I, Alvah F. Hughes, certify that this Corner record correctly represents work performed by me or under my direction in compliance with the "Corner Recordation Act" (79-22-101, et seq., MCA).

Signature of Surveyor & Seal

Date: 1/11/2007 Reg. No. 7322-LS

Employer: Kootenai Surveyors Inc.

Office of Clerk and Recorder, County of Lincoln This "corner

record" was filed for record on 200808 BOOK: CCR CC&R'S PAGE: 11013 Pages: 1

was noted on the cross-section STATE OF MONTANA LINCOLN COUNTY

book No. RECORDED: 02/06/2007 1:09 KOI: CC&R'S

TAMMY D. LAUER CLERK AND RECORDER

FEE: \$0.00

BY: [Signature]

TO: FILED

Cross Index No. K 06 T. 29N R. 27W P.M.; MT

Adopted July 1, 1981, Montana Board of Professional Engineers & Land Surveyors

Sec.17

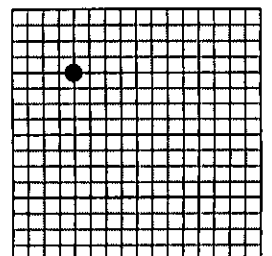

• corner this sheet